

Huff House Employee Housing  
 Replace temporary housing with permanent facilities,  
 164 beds and 164 parking spaces

- 1 Construct 4 two-story buildings for 32 occupants, 8 occupants per building.
- 2 Construct 11 two-story buildings for 132 occupants, 12 occupants per building.
- 3 Provide common recreational area, approximately 3,600 square feet.
- 4 Build plaza areas and walkways with site furnishings, accent paving, and enhanced landscaping.
- 5 Construct a shuttle bus stop.
- 6 Remove ice rink and bicycle rentals. Construct an employee parking facility with 164 spaces.
- 7 Retain historic residence for housing purposes.

Curry Orchard Parking Area

- 8 Improve parking area with 300 spaces and landscape buffers with trees and bioswales that will treat storm water run-off. Provide pedestrian walkways.

Stoneman Meadow Restoration

- 9 Remove Stoneman Road and adjacent recreation trail. Extend boardwalk from existing terminus (at Stoneman Road) to Curry Village Pavilion area, improve hydrology, remove invasive species, promote weed control and plant native species.

Boys Town

- 10 Remove existing guest accommodations and ecologically restore lands.
- 11 Relocate Campground Reservation Center and provide 8 parking spaces.
- 12 Construct a roadway to connect Curry Village and East Valley campgrounds. Provide additional roadside parking.

Existing Curry Village Visitor Services

- 13 Retain existing historic cabins and Stoneman Cottage (65 lodging units).
- 14 Retain existing Curry Pavilion.
- 15 Retain 290 tents.

\*These drawings are provided to demonstrate where facilities would be removed, relocated, or constructed according to actions more fully described by project alternatives. The drawings do not represent a final proposal. More detailed design and construction documents would be developed consistent with the general concepts presented here.



**Alternative 3**  
**Conceptual Site Drawing for**  
**Curry Village**

Yosemite National Park  
 United States Department of the Interior • National Park Service

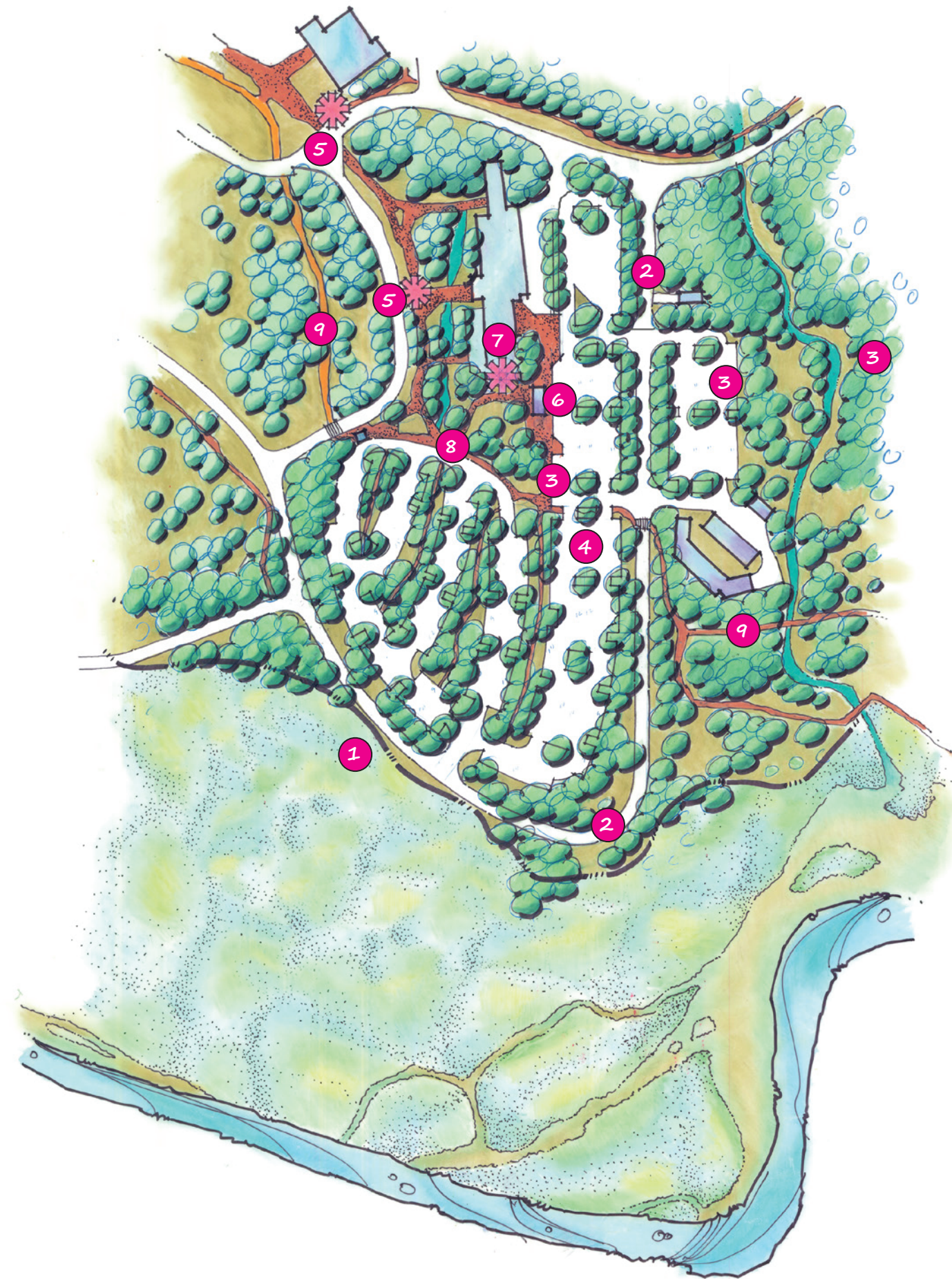

- 1 Use the 10-year floodplain to establish limits of development. Restore wetlands and meadow.
- 2 Reroute Northside Drive to conform to the floodplain extent and south edge of day-use parking area. Northside Drive is eliminated east of this location.
- 3 Eliminate Concessioner General Office and Garage between the Village Store and Ahwahnee Meadow, providing more space for visitor parking. Employee dormitories and housing would be removed in Alternative 2 (as drawn), but retained in Alternative 3.
- 4 Provide 550 day-use parking spaces in between Northside Drive and Yosemite Village. Integrate landscaped areas to retain large numbers of trees, and include bioswales that will treat storm water run-off. Improve access through a system of pedestrian pathways leading to the Yosemite Village mall.
- 5 Retain existing shuttle stops on Visitor Center Loop Drive.
- 6 Establish bus passenger unloading area east of the Yosemite Village mall.
- 7 Replace Village Sport Shop with visitor contact station.
- 8 Eliminate art activity center and improve pedestrian access.
- 9 Improve pedestrian connections and bike paths east and west of the day-use parking area.



**Alternatives 2 and 3**  
**Conceptual Site Drawing for**  
**Yosemite Village Day-use Parking Area**  
 Yosemite National Park  
 United States Department of the Interior • National Park Service

\*These drawings are provided to demonstrate where facilities would be removed, relocated, or constructed according to actions more fully described by project alternatives. The drawings do not represent a final proposal. More detailed design and construction documents would be developed consistent with the general concepts presented here.



1 Move pedestrian crossing to Yosemite Falls west of the existing intersection.

2 Maintain parking for overnight guests.

3 Enhance pedestrian circulation system.

4 Construct tour bus loading and unloading area, with shelter.

5 Construct employee housing in 2 two-story buildings with 52 occupants per building and 39 employee parking spaces per building.

6 Relocate linen storage and laundry buildings to an addition to the food service building. Reconfigure truck loading and unloading area.

7 Remove existing NPS volunteer office and 4 guest lodging buildings from the 100-year floodplain, restore vegetation and hydrological processes.

8 Construct 150 day-use parking spaces at Yosemite Lodge Day-use Parking Area. Maintain existing vegetation as buffers to separate and screen parking bays, provide pedestrian pathways and bioswales that will retain storm water run-off.

9 Construct 15 tour bus parking spaces.

10 Construct a shuttle bus stop with shelter and comfort station.

11 Construct 41 additional parking spaces at Camp 4.

12 Retain 35 existing walk-in campsites at Camp 4. Construct 35 additional walk-in sites opposite existing parking facility. Occupancy is limited to 6 campers per site. Standard walk-in campsite is 3,850 square feet (70-foot diameter), including 1,200 square feet of clearance with a 15-foot perimeter buffer.

13 Protect and enhance a 150-foot riparian buffer.



\* These drawings are provided to demonstrate where facilities would be removed, relocated, or constructed according to actions more fully described by project alternatives. The drawings do not represent a final proposal. More detailed design and construction documents would be developed consistent with the general concepts presented here.

**Alternative 3**  
**Conceptual Site Drawing for**  
**Yosemite Lodge and Camp 4**  
 Yosemite National Park  
 United States Department of the Interior • National Park Service