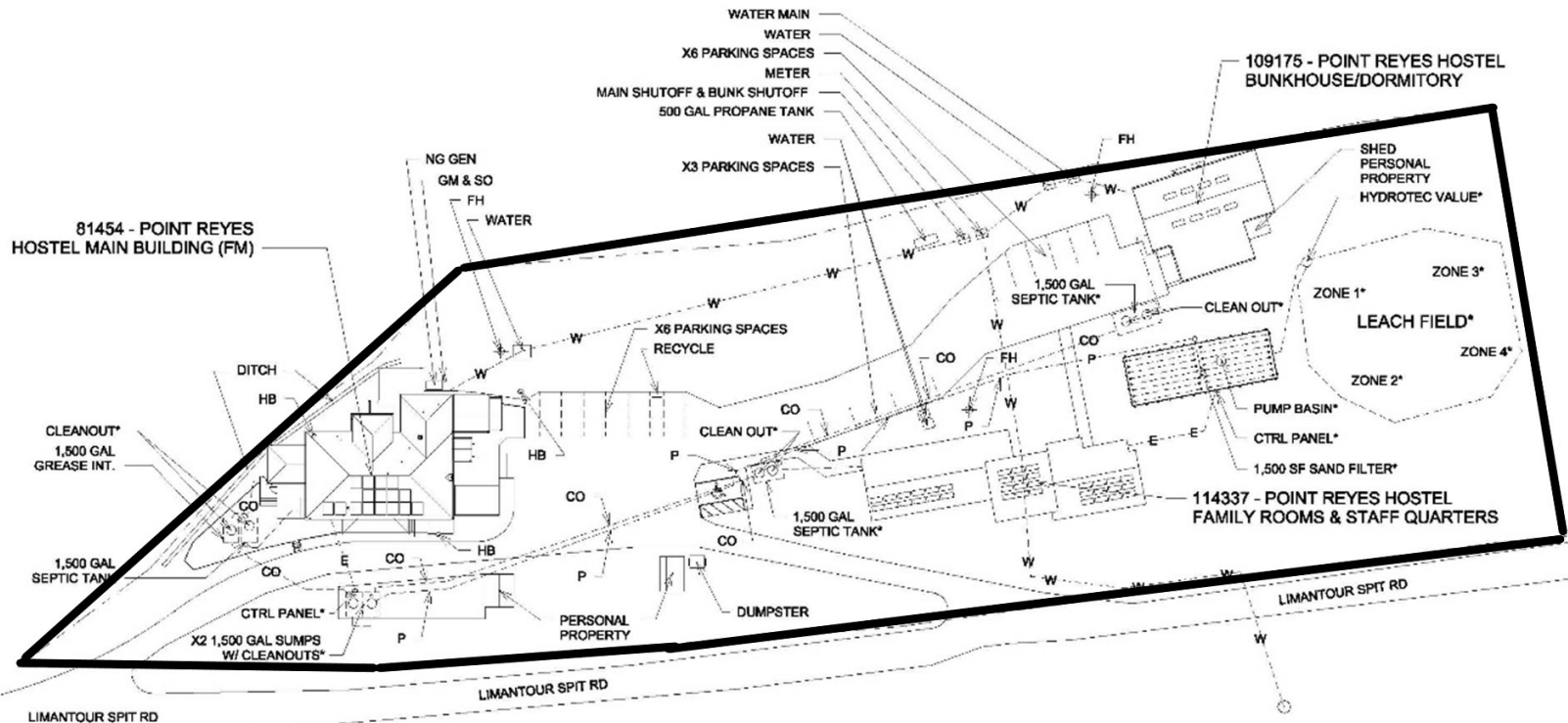

EXHIBIT C

**ASSIGNED LAND AND REAL PROPERTY IMPROVEMENTS
(CONCESSION FACILITIES)**

Land Assigned

Land is assigned in accordance with the boundaries shown on the following map[s]:



LEGEND:
 HB HOSE BIBB
 FH FIRE HYDRANT
 GM & SO GAS METER & SHUTOFF
 NG GEN NATURAL GAS GENERATOR
 CTRL CONTROL
 2558 - POINT REYES NS SEWAGE SYSTEM AMERICAN YOUTH HOSTEL - SYSTEM COMPONENTS
 CO CLEANOUT LINE
 W WATER LINE
 P PLUMBING
 E ELECTRICAL CONDUIT
 CONFESSIONAIRE BOUNDARY LINE

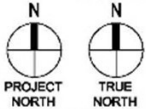

SITE PLAN

	CONDITION ASSESSMENT MARCH 9, 2019	TITLE OF PROJECT PORE HOSTEL AREA SITE PLAN	DRAWING NO. -
	UNITED STATES DEPARTMENT OF THE INTERIOR	CONCESSION ID PORE003	PMSG NO. -
	NATIONAL PARK SERVICE PACIFIC WEST	LOCATION WITHIN PARK POINT REYES HOSTEL AREA	SHEET -
		NAME OF PARK POINT REYES NATIONAL SEASHORE REGION PACIFIC WEST	COUNTY MARIN STATE CALIFORNIA

BASIC DATA: PORE003-POINT REYES HOSTEL AREA SITE PLAN-021.DWG

Real Property Improvements Assigned

The following real property improvements are assigned to the Concessioner for use in conducting its operations under this Contract.

Asset Code	Asset Description	Asset Type	Qty	Date Built or Installed	Historic (Y or N)	Insurance Replacement Value
81454	American Youth Hostel Main Building	4100	3,046 SF	1870	N	\$1,097,318
109175	American Youth Hostel Bunkhouse	4100	1,544 SF	1980	N	\$547,149
114337	Point Reyes Hostel Family Rooms and Staff Quarters	4100	2,640 SF	2011	N	\$885,498
2556	Sewage System American Youth Hostel	4100	180 GPD	2000	N	N/A

**Please note: The lack of value for an asset in the column for Insurance Replacement Value does not relieve the Concessioner of its obligation to insure the asset according to the terms of this Contract.*

Approved, effective _____, 20____

By: _____
 Frank Lands
 Regional Director, National Park Service
 Interior Regions 8, 9, 10 and 12