

EXHIBIT C**ASSIGNED LAND AND REAL PROPERTY IMPROVEMENTS
(CONCESSION FACILITIES)****Land Assigned**

Land is assigned in accordance with the boundaries shown on the following map[s]:

Office Area: Approximately 1.2 acres of land as shown on the map, Attachment #1 to this exhibit.

Employee Housing Area: Approximately 2.5 acres of land as shown on the map, Attachment #2 to this exhibit. No real property improvements are assigned to the concessioner within this land assignment.

Lower Saddle Area: Approximately 300 sq. ft. of land on the Lower Saddle for an overnight camp for clients as shown on the map, Attachment #3 to this exhibit. No real property improvements are assigned to the concessioner within this land assignment.

Real Property Improvements Assigned

The following real property improvements are assigned to the Concessioner for use in conducting its operations under this Contract. Insurance Replacement Values are subject to change and may be updated throughout the Contract term.

Asset Code	Asset Description	Asset Type	Unit of Measure	Quantity	Date Built or Installed	Historic (Y or N)	Insurance Replacement Value
31420	(CN) B-Climbing School Office (CCC Bath house) (HS)0070	4100	920	GSF	1935	Y	\$205,431
31421	(CN) B-Climbing School Storage (CCC Mess hall) (HS)0069	4100	2,240	GSF	1935	Y	\$541,650
233453	(CN) ML – Climbing School Office Maintained Landscape	3100	1.2	AC	1935	N	\$15,272
250811	(CN) P – Climbing School Parking Area	1300	19,890	SF	1950	N	\$39,726
250812	(CN) ML – Climbing School Employee Area Maintained Landscape	3100	2.5	AC	1980	N	\$40,625
250814	(CN) B- Climbing School Vault Toilet	4100	82	GSF	2001	N	\$59,220
						Total	\$901,924

Approved, effective _____, 20____

By: _____

Kate H. Hammond

Regional Director, Interior Regions 6, 7 and 8

National Park Service

Attachment #1 Office Area

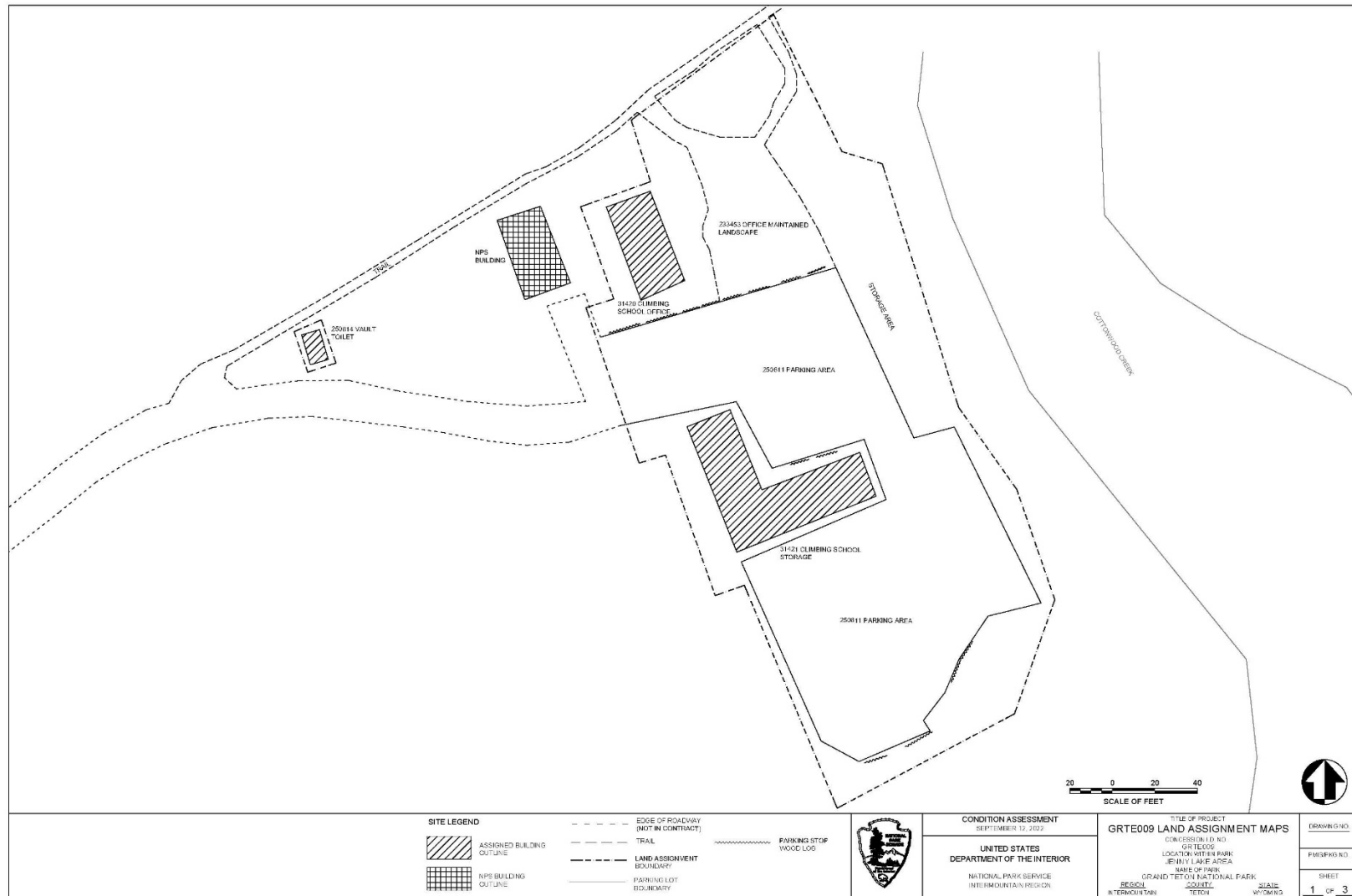

Attachment #2 Employee Housing Area

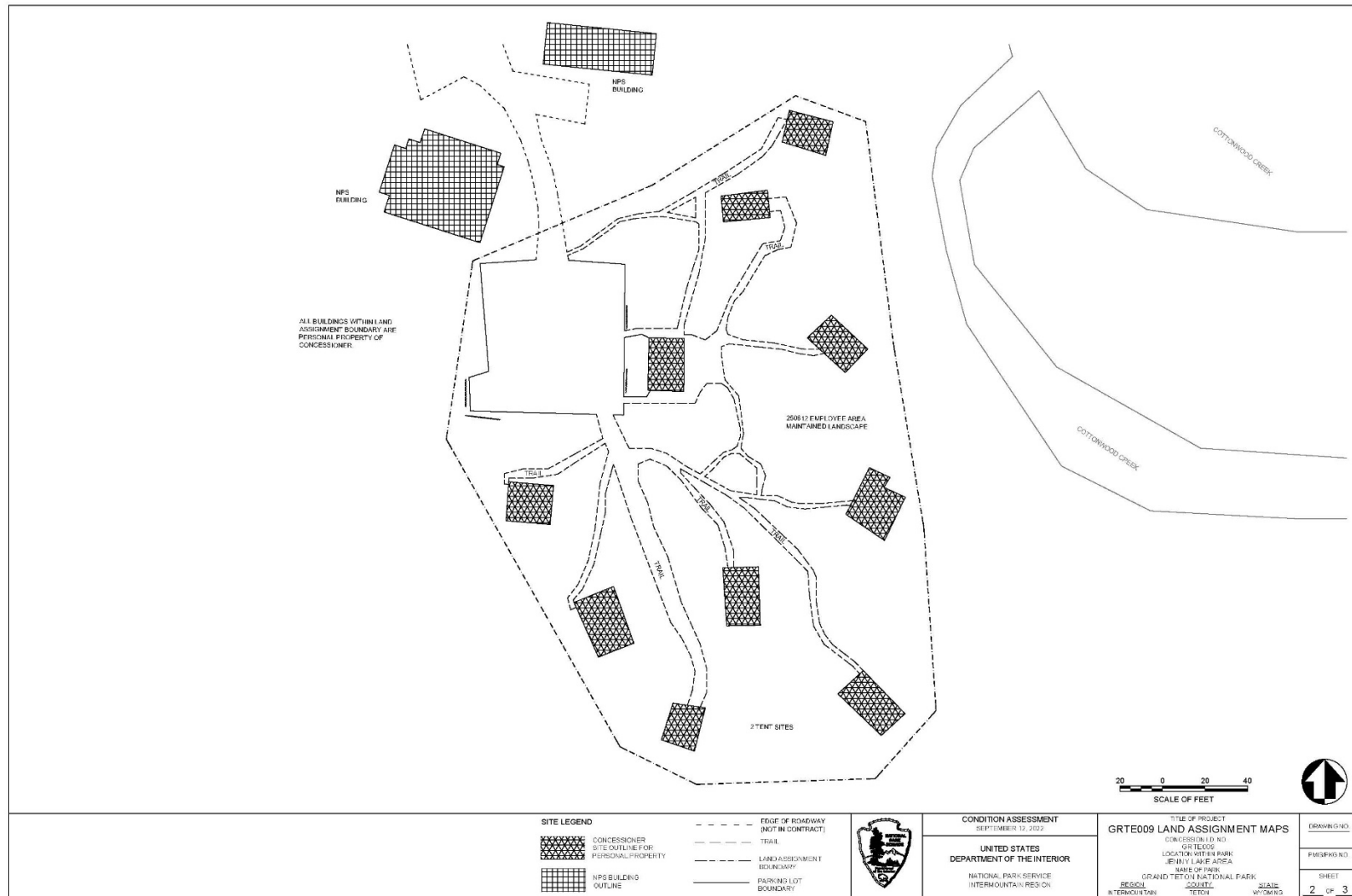

Attachment #3 Lower Saddle

