

CFIP 2: Develop Accessible First Floor Suite

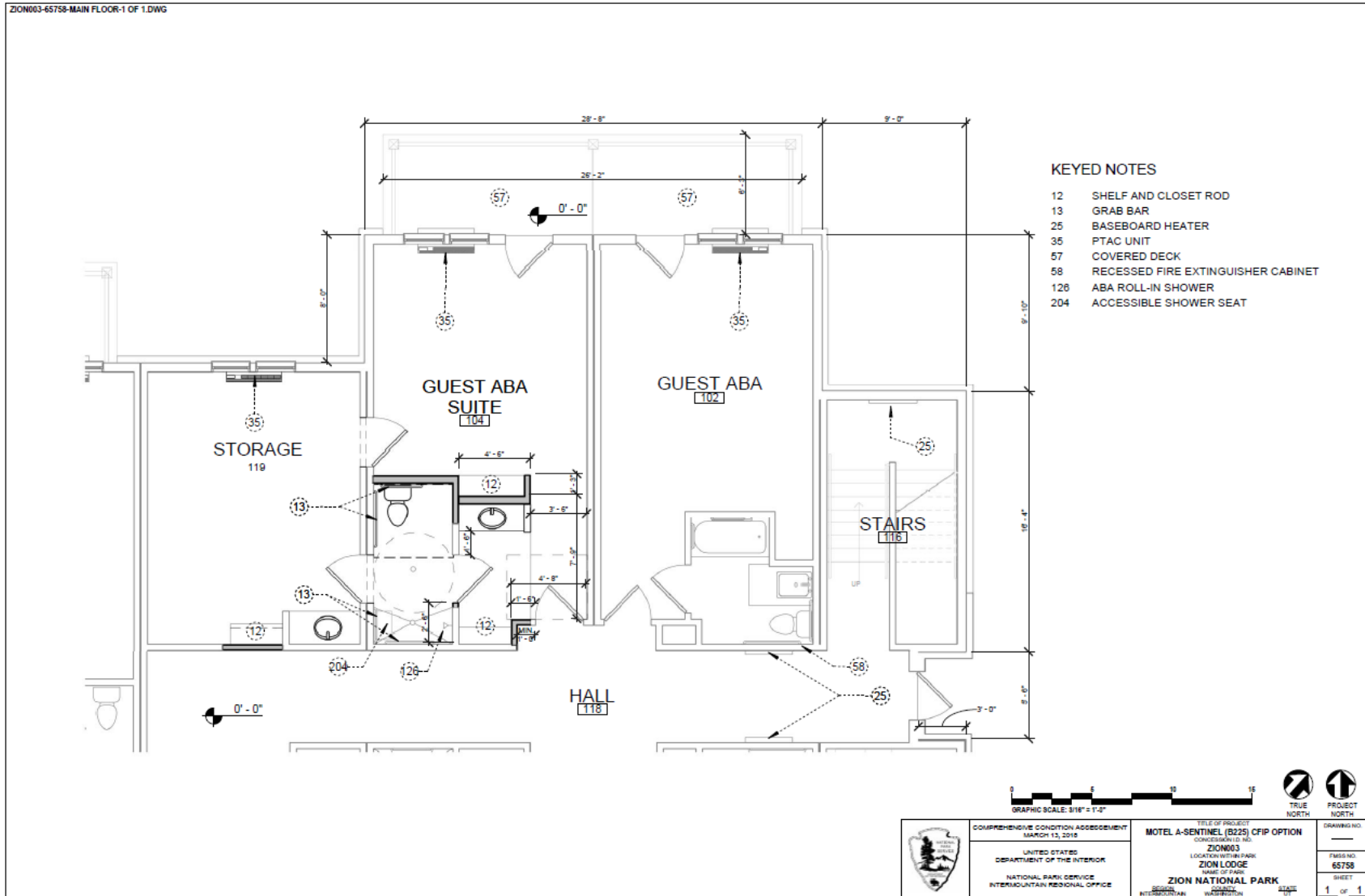

CFIP 3: Convert Cabin for Accessibility

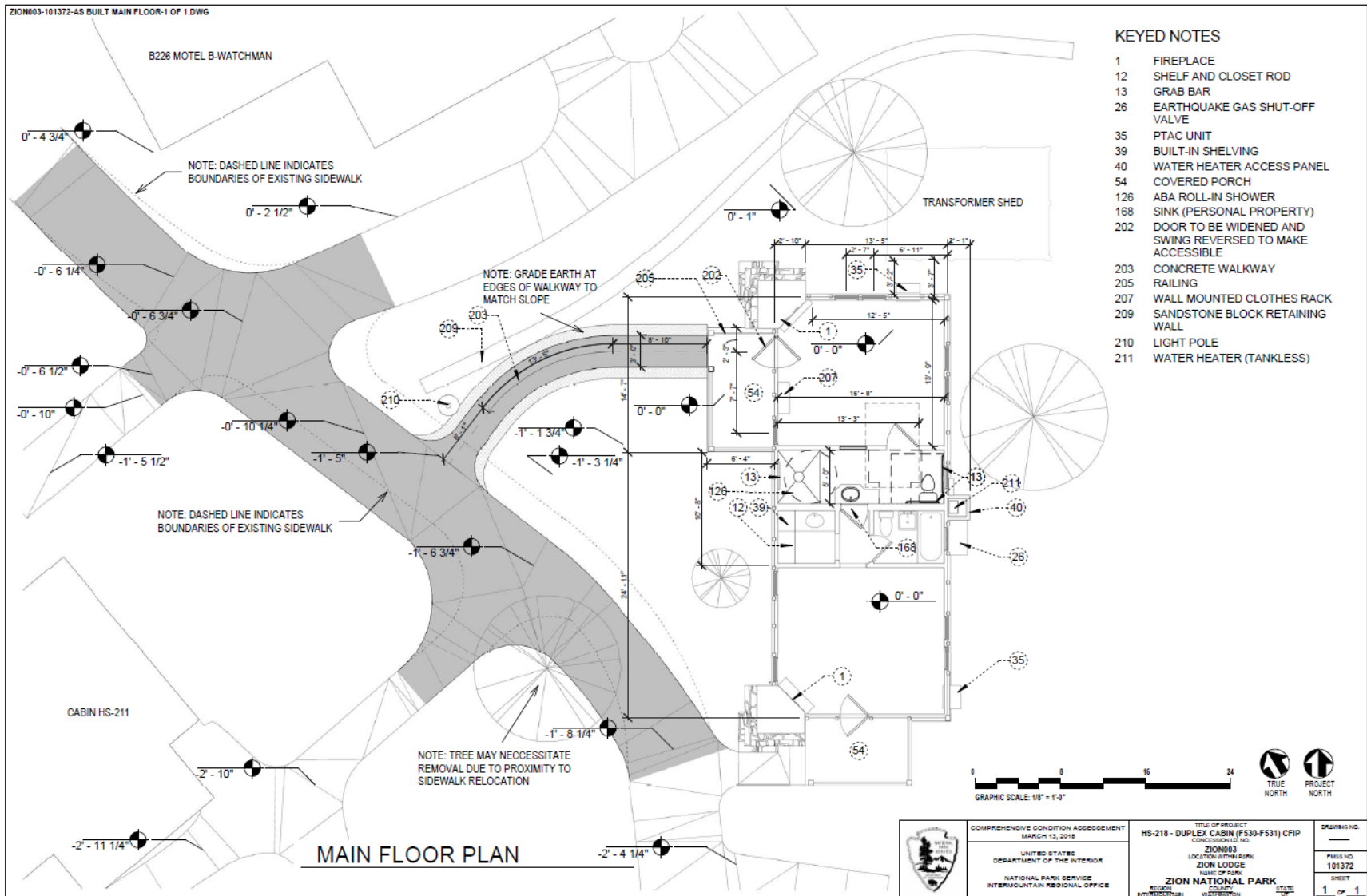

KEYED NOTES

- 1 FIREPLACE
- 12 SHELF AND CLOSET ROD
- 13 GRAB BAR
- 26 EARTHQUAKE GAS SHUT-OFF VALVE
- 35 PTAC UNIT
- 39 BUILT-IN SHELVING
- 40 WATER HEATER ACCESS PANEL
- 54 COVERED PORCH
- 126 ABA ROLL-IN SHOWER
- 168 SINK (PERSONAL PROPERTY)
- 202 DOOR TO BE WIDENED AND SWING REVERSED TO MAKE ACCESSIBLE
- 203 CONCRETE WALKWAY
- 205 RAILING
- 207 WALL MOUNTED CLOTHES RACK
- 209 SANDSTONE BLOCK RETAINING WALL
- 210 LIGHT POLE
- 211 WATER HEATER (TANKLESS)

CFIP 4: Improve Access to Retail Storage Space

