

## **EXHIBIT D**

### **ASSIGNED LAND AND REAL PROPERTY IMPROVEMENTS (CONCESSION FACILITIES)**

#### **Land Assigned**

Land is assigned in accordance with the boundaries shown on the following map.

Page D-2: Land Assignment—Price Lake

## Land Assignment—Price Lake

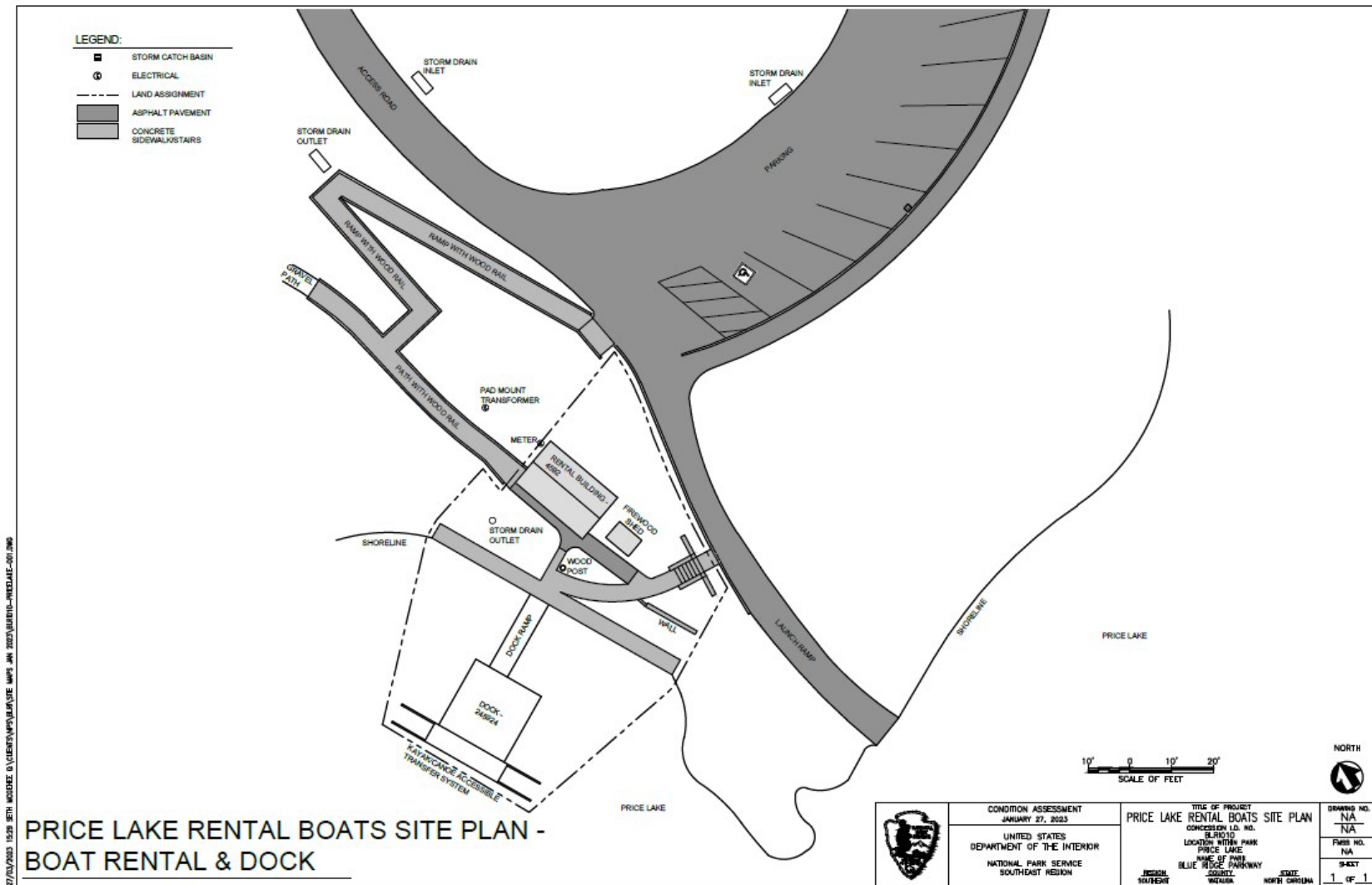

**Real Property Improvements Assigned**

The following real property improvements are assigned to the concessioner for use in conducting its operations under this Contract:

<b>Asset Code</b>	<b>Asset Description</b>	<b>Asset Type</b>	<b>Unit of Measure</b>	<b>Quantity</b>	<b>Date Built or Installed</b>	<b>Historic (Y or N)</b>	<b>Insurance Replacement Value</b>
4592	Rental Building	4300	SF	205	1984	N	\$12,282
245924	Boat Dock	6300	LF	16	2016	N	\$53,618

\* Please note: The lack of value for an asset in the Insurance Replacement Value column does not relieve the Concessioner of its obligation to insure the asset according to the terms of this Contract.

Approved, effective \_\_\_\_\_, 20\_\_.

By: \_\_\_\_\_  
Regional Director, Interior Region 2