

EXHIBIT D

ASSIGNED LAND AND REAL PROPERTY IMPROVEMENTS (CONCESSION FACILITIES)

Land Assigned

Land is assigned in accordance with the boundaries shown on the following map.

Page D-2: Land Assignment—Price Lake

Land Assignment—Price Lake

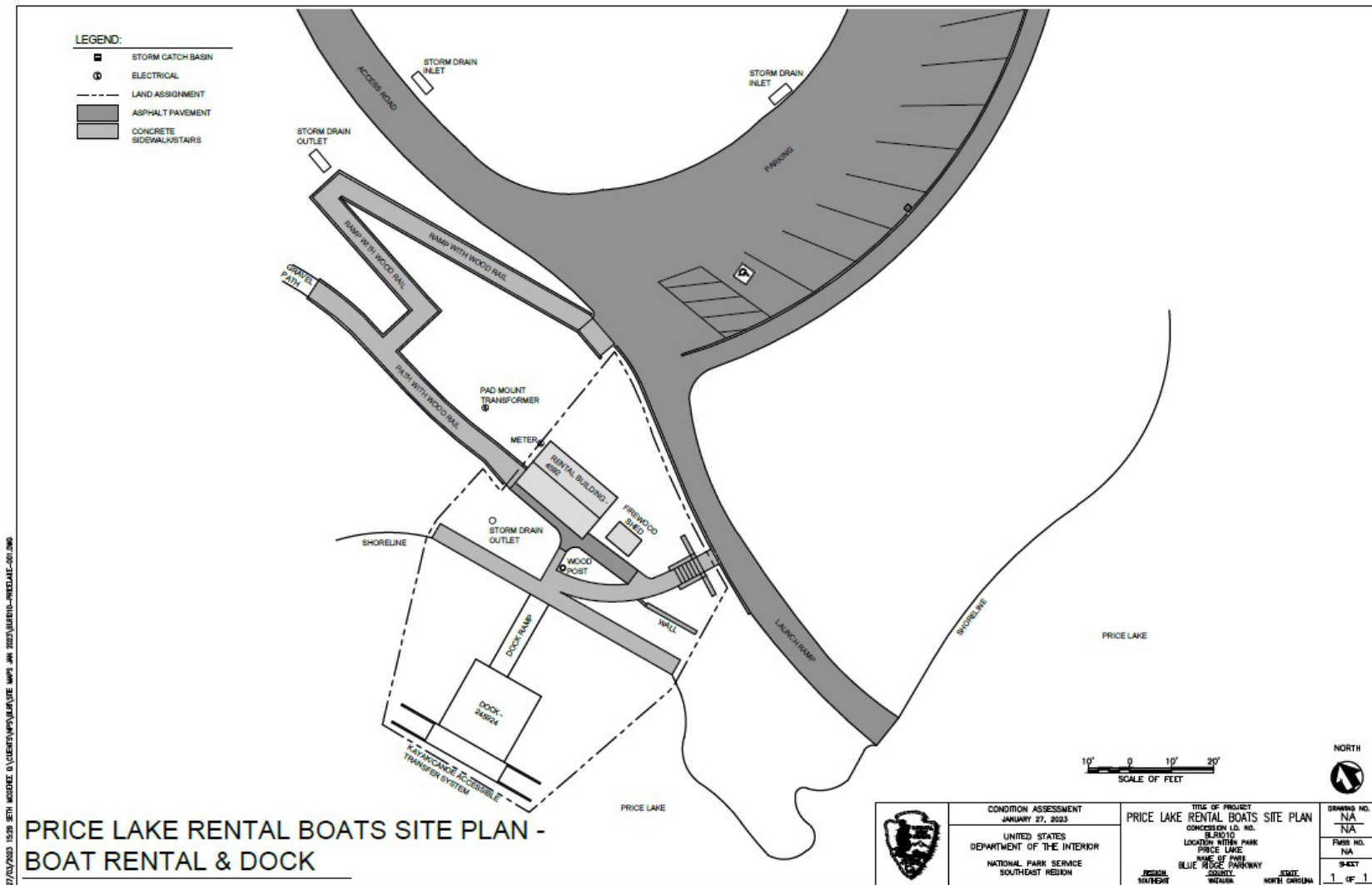

27/01/2023 15:39 WITH MODIFIED IN CLIENT'S MAPS/BLP SITE MAPS JAN 2023/BLP/BLP-PRICE LAKE-201.2023

Real Property Improvements Assigned

The following real property improvements are assigned to the concessioner for use in conducting its operations under this Contract:

Asset Code	Asset Description	Asset Type	Unit of Measure	Quantity	Date Built or Installed	Historic (Y or N)	Insurance Replacement Value
4592	Rental Building	4300	SF	205	1984	N	\$12,282
245924	Boat Dock	6300	LF	16	2016	N	\$53,618

* Please note: The lack of value for an asset in the Insurance Replacement Value column does not relieve the Concessioner of its obligation to insure the asset according to the terms of this Contract.

Approved, effective _____, 20__.

By: _____
Regional Director, Interior Region 2