



Youth Stewardship

Engaging local youth in the planning and development
of conservation and outdoor recreation projects

The National Park Service works to involve youth in the planning of conservation
and outdoor recreation projects as part of the community engagement process.



NPS-RTCA

The National Park Service **Rivers, Trails and Conservation Assistance Program**

About Us

The **National Park Service**, through the **Rivers, Trails and Conservation Assistance** program (NPS-RTCA), has supported locally-led conservation and outdoor recreation projects across the United States for more than 30 years. NPS-RTCA assists communities in developing or restoring parks, conservation areas, rivers, and wildlife habitats, as well as creating outdoor recreation opportunities and programs that engage future generations in the outdoors. Through an annual application process, community groups, nonprofit organizations, tribal governments, national parks, and local, state and federal agencies can apply for NPS-RTCA technical assistance.

Our Model

Across the country, NPS-RTCA staff pair their professional planning, design and technical expertise with your team and knowledge experts from the community. Together, our 1 to 2 year-long partnership works to achieve your conservation and outdoor recreation vision. Based on the complexity of the project, we tailor our assistance to meet your needs and help you navigate a path to success. Although NPS-RTCA is not a grant-funding program, we can help your organization identify potential funding sources for your project.

Community Engagement

As a collaborative partner, we strive to achieve successful project outcomes by engaging communities in the visioning, planning and implementation of each project. We encourage strong community partnerships and facilitate meaningful engagement to ensure your conservation and outdoor recreation projects last into perpetuity.

Bridge to Backman Community Open Space

Salt Lake City Parks and Public Lands Parcel 592 N Riverside Drive (~1550 W 700 N)

Proposed Site Improvements

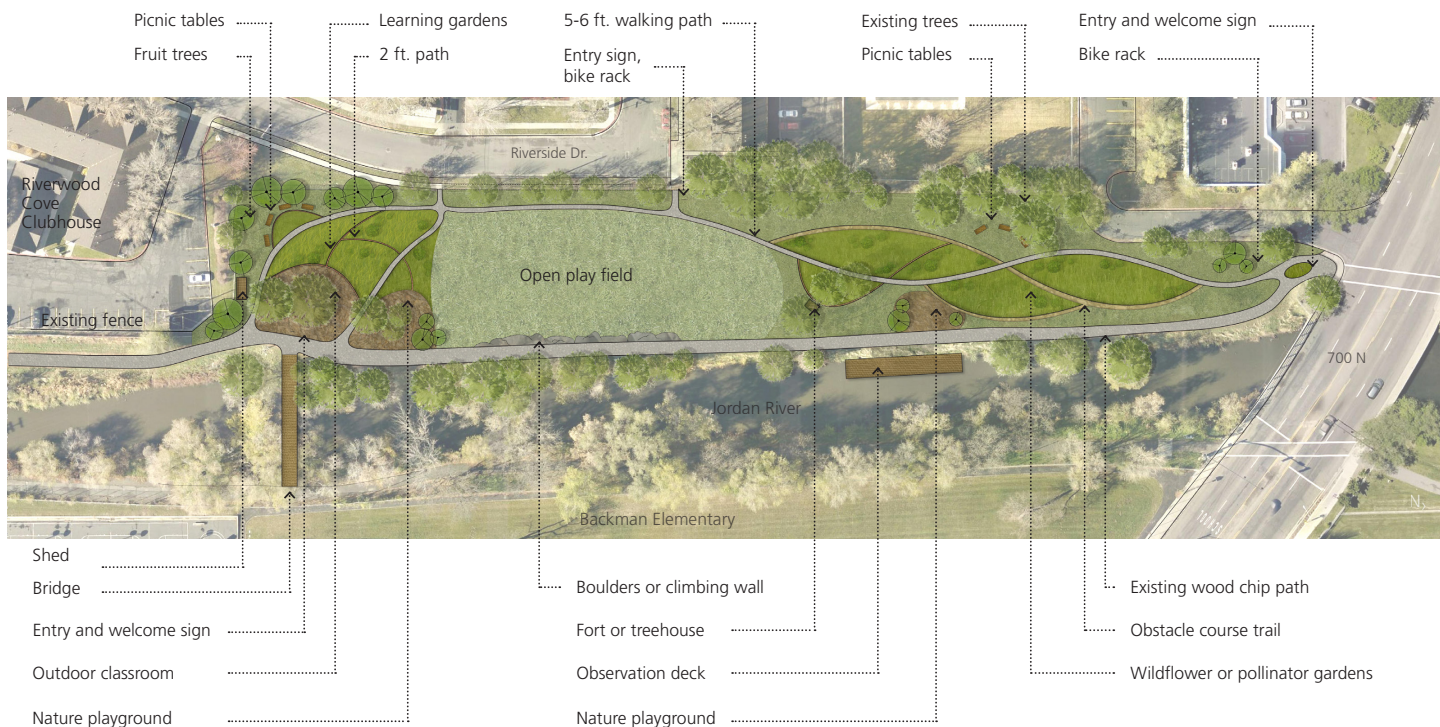

Utah

Bridging the Gap at Backman Elementary School

Educators often employ a metaphor about “building bridges” when identifying what they need to strengthen their schools and better connect with the communities they serve. At Backman Elementary School in Salt Lake City, Utah, school officials were being quite literal: they needed to build a bridge.

Home to a vibrant and diverse community, Backman Elementary is uniquely situated next to the Jordan River. However, for many students, the walk to school was along a busy highway with no sidewalk. At the request of the school, NPS-RTCA facilitated a series of meetings with community leaders, teachers and students to plan a nature area for outdoor education and a safe pedestrian bridge to connect the school to the local neighborhoods.

Moving forward, NPS staff from Timpanogos Cave National Monument will provide educational programming, participate in Backman’s Career and College Night to promote NPS careers, and keep creating opportunities for youth to get on the water through a partnership with the Wilderness Inquiry.



Frequently Asked Questions

Who are we?

The **National Park Service – Rivers, Trails and Conservation Assistance program (NPS-RTCA)** assists communities, public land managers and nonprofit organizations with conservation and outdoor recreation projects. NPS-RTCA provides professional planning, design and technical expertise to help achieve your conservation and outdoor recreation vision.

Does NPS-RTCA provide funding?

No. NPS-RTCA is not a grant-funding program, but we can help you identify potential funding sources for your project.

What kind of projects does NPS-RTCA support?

Our program staff support locally-led projects that develop or restore parks, conservation areas, rivers, and wildlife habitats, as well as create outdoor recreation opportunities and programs that engage future generations in the outdoors.

Are NPS-RTCA staff contractors?

The NPS-RTCA model is to combine the skills of our staff with those of your organization. It's a partnership – we work alongside your team and local knowledge experts to assist with the work that you are leading.

How much time do NPS-RTCA staff spend on each project?

Typically, NPS-RTCA staff collaborate with communities for 1 to 2 years on conservation and outdoor recreation projects. Depending on the complexity of the project and our staffing capacity, the time frame may be extended.

Who can apply for assistance from NPS-RTCA?

NPS-RTCA provides services to established community groups, nonprofit organizations, tribal governments, national parks, and local, state and federal agencies.

How can you apply for assistance from NPS-RTCA?

NPS-RTCA support is provided when we are invited to assist you on a conservation or outdoor recreation project. We encourage you to contact us to discuss your project before applying. The application is available on our website: www.nps.gov/RTCA

 nps.gov/RTCA

 NPS_RTCA@nps.gov

 facebook.com/RTCANPS

 [twitter: @RTCANPS](https://twitter.com/RTCANPS)

National Park Service
U.S. Department of the Interior

