

MERCED AND TUOLUMNE RIVERS

Draft Comprehensive River Management Plans and Environmental Impact Statements

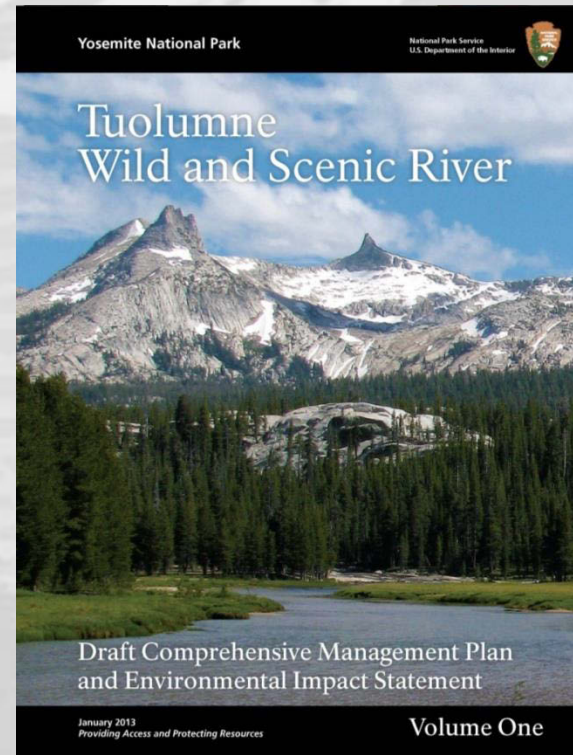

**Mariposa Public Meeting
March 7, 2013**

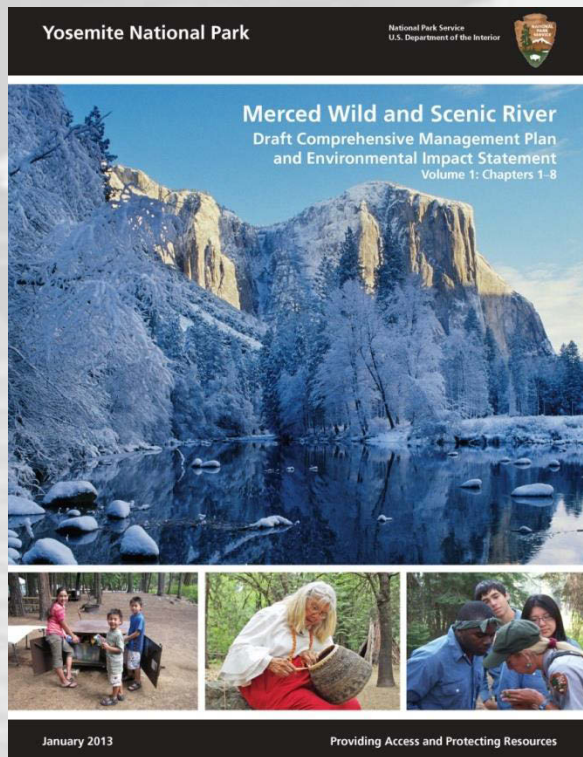

Tuolumne Wild and Scenic River

YOSEMITE NATIONAL PARK

Merced Wild and Scenic River



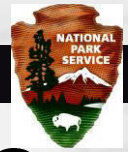

Wild and Scenic Rivers Act of 1968

- Protects free-flowing condition
- Protects water quality
- Protects and enhances the river's *Outstandingly Remarkable Values (ORVs)*– the qualities that make the river worthy of special protection
- Requires management plans to be completed to provide long-term guidance**



A scenic landscape featuring a river in the foreground, a dense forest of evergreen trees in the middle ground, and rugged mountains in the background. The sky is clear and blue. The text is overlaid on the image.

*“Each [river] will be managed to **protect and enhance** the values for which the river was designated, while providing for public recreation and resource uses which do not **adversely impact or degrade** those values.”*

WSRA Guidelines, 1982

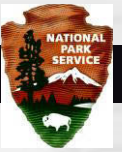

Actions to Protect and Enhance River Values

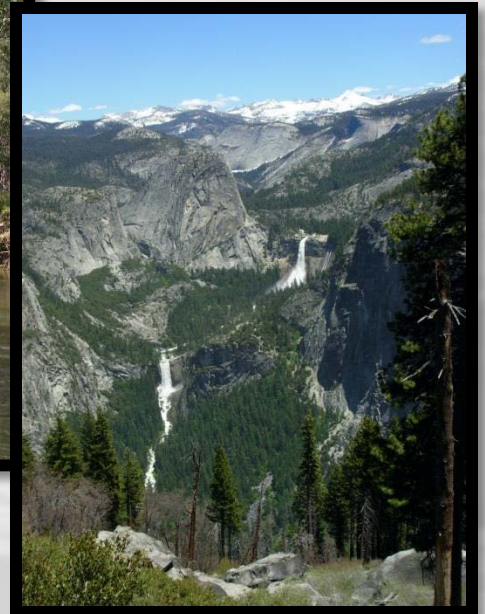

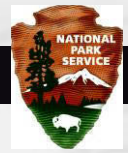

Merced Baseline Condition Assessment

- Draft Baseline Conditions Report updated July 2012 – see Chapter 5
- Localized impacts to El Capitan Meadow
- Riparian areas between Clark's and Sentinel Bridges
- Hydrologic impacts of Sugarpine Bridge
- Informal trails through valley meadows
- Condition of National Historic Landmarks



Flooded informal trail in El Capitan Meadow

Localized riparian impacts



Hydrologic impacts of Sugar Pine Bridge

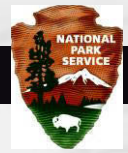

Restore Yosemite Valley Meadows

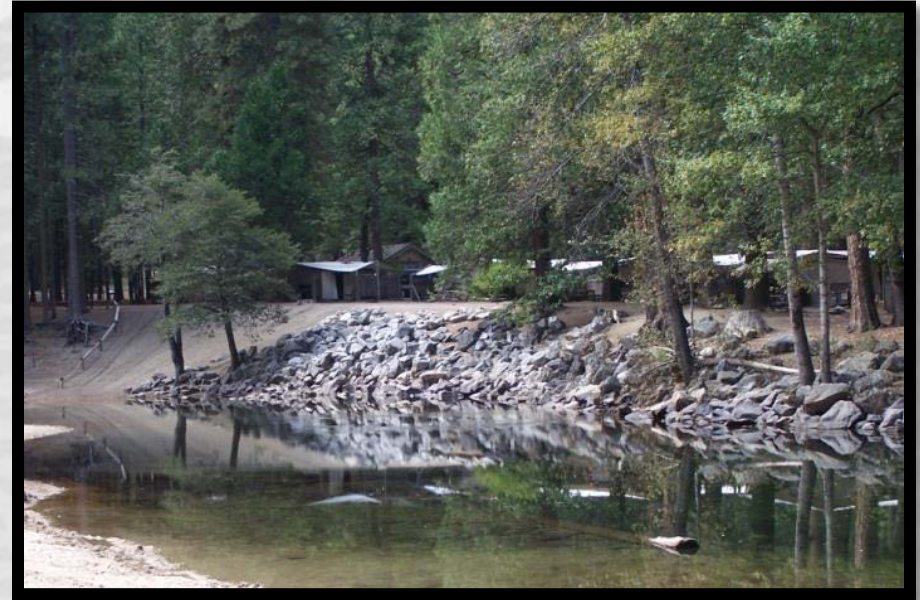
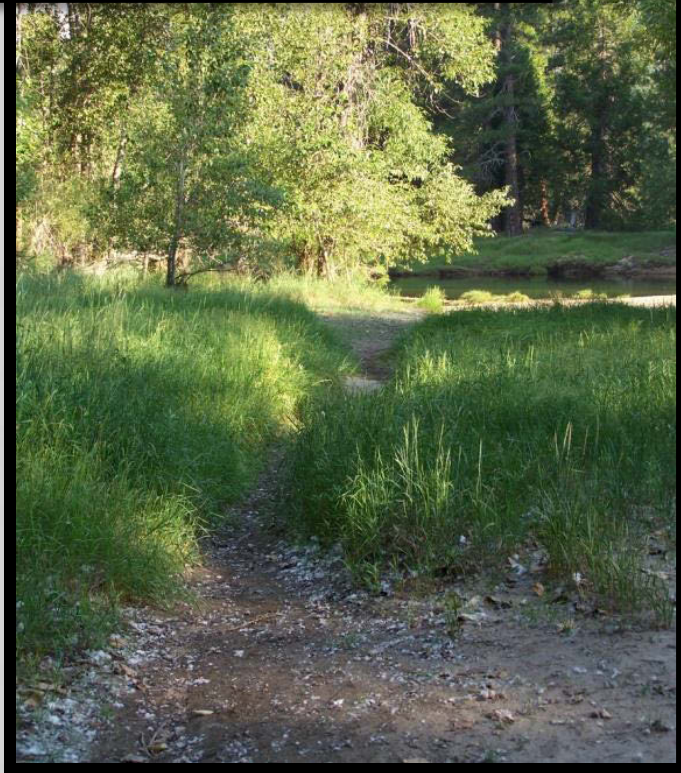
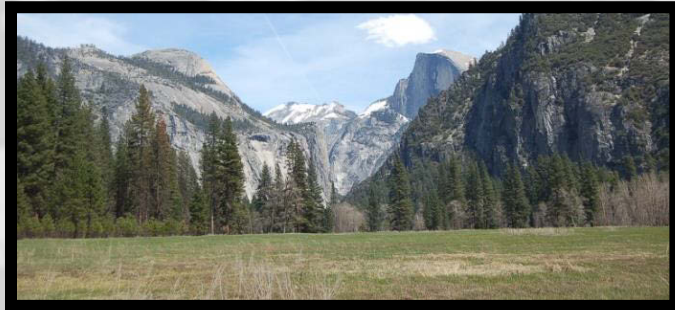

Remove Riverbank Riprap



Historic Preservation



Correct Impacts to Free-Flow

ALTERNATIVE 5 CURRY VILLAGE AND CAMPGROUNDS

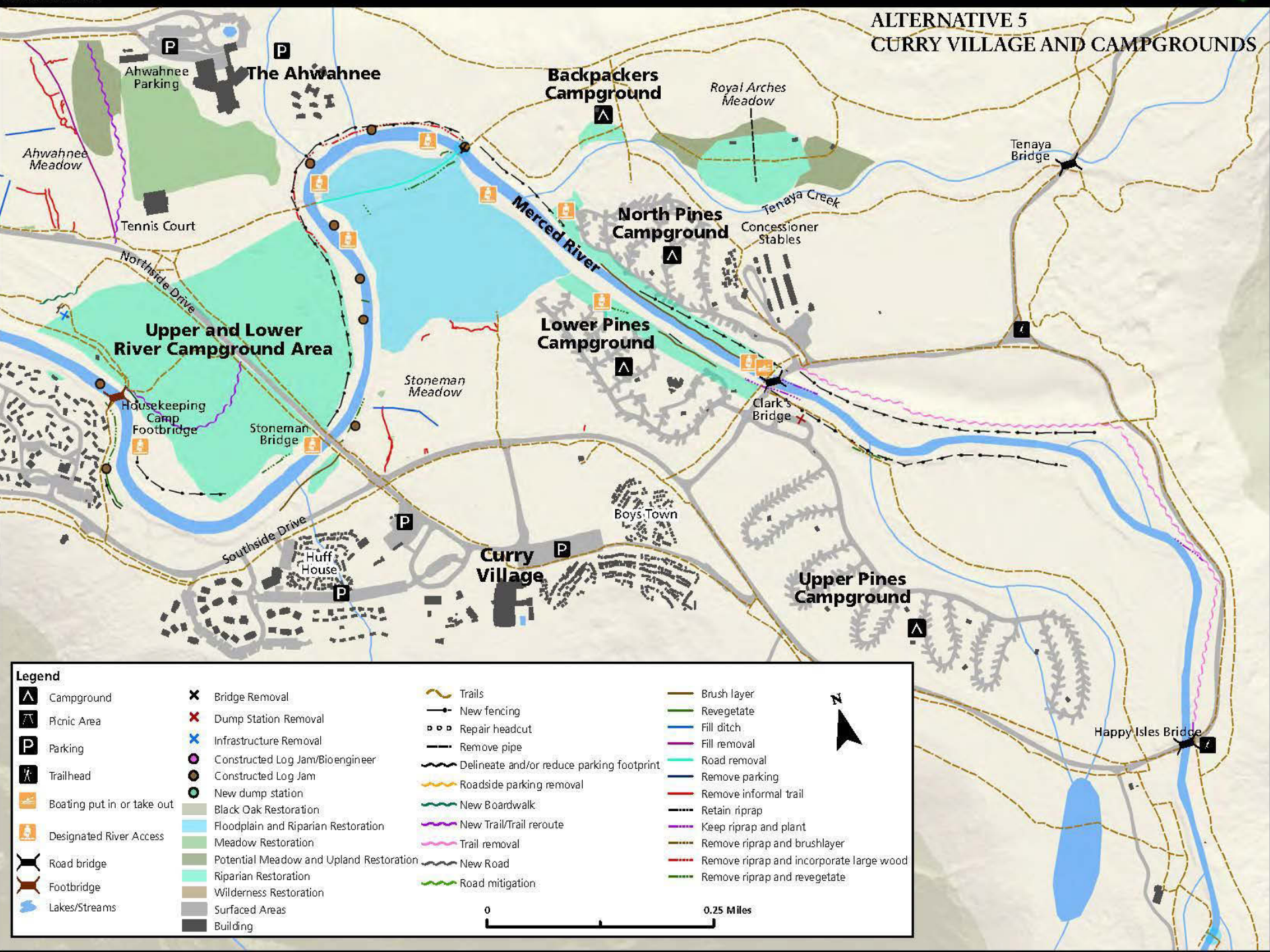

Legend

	Campground		Bridge Removal		Trails		Brush layer
	Picnic Area		Dump Station Removal		New fencing		Revegetate
	Parking		Infrastructure Removal		Repair headcut		Fill ditch
	Trailhead		Constructed Log Jam/Bioengineer		Remove pipe		Fill removal
	Boating put in or take out		Constructed Log Jam		Delineate and/or reduce parking footprint		Road removal
	Designated River Access		New dump station		Roadside parking removal		Remove parking
	Road bridge		Black Oak Restoration		New Boardwalk		Remove informal trail
	Footbridge		Floodplain and Riparian Restoration		New Trail/Trail reroute		Retain riprap
	Lakes/Streams		Meadow Restoration		Trail removal		Keep riprap and plant
			Potential Meadow and Upland Restoration		New Road		Remove riprap and brushlayer
			Riparian Restoration		Road mitigation		Remove riprap and incorporate large wood
			Wilderness Restoration				Remove riprap and revegetate
			Surfaced Areas				
			Building				

0 0.25 Miles

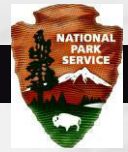

Merced River Plan Facilities Analysis

Facilities Removed – Under All Alternatives

- **Curry Village and Yosemite Lodge temporary employee housing**
- **The Ahwahnee Swimming Pool and Tennis Court**
- **Yosemite Village Concessioner Garage and Concessioner General Office**
- **Yosemite Lodge Swimming Pool, Snack Stand, Bike Stand, and Post Office**
- **Yosemite Art Activity Center**
- **Happy Isles Snack Stand**
- **Curry Village Ice Rink, Bike Stand, and Raft Stand**
- **Commercial Horseback Day Rides in Yosemite Valley**
- **Odgers Bulk Petroleum Storage in El Portal**
- **Old Wastewater Treatment Plant in El Portal**

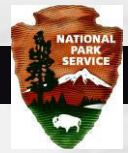

WSRA Requirements for Facilities Analysis

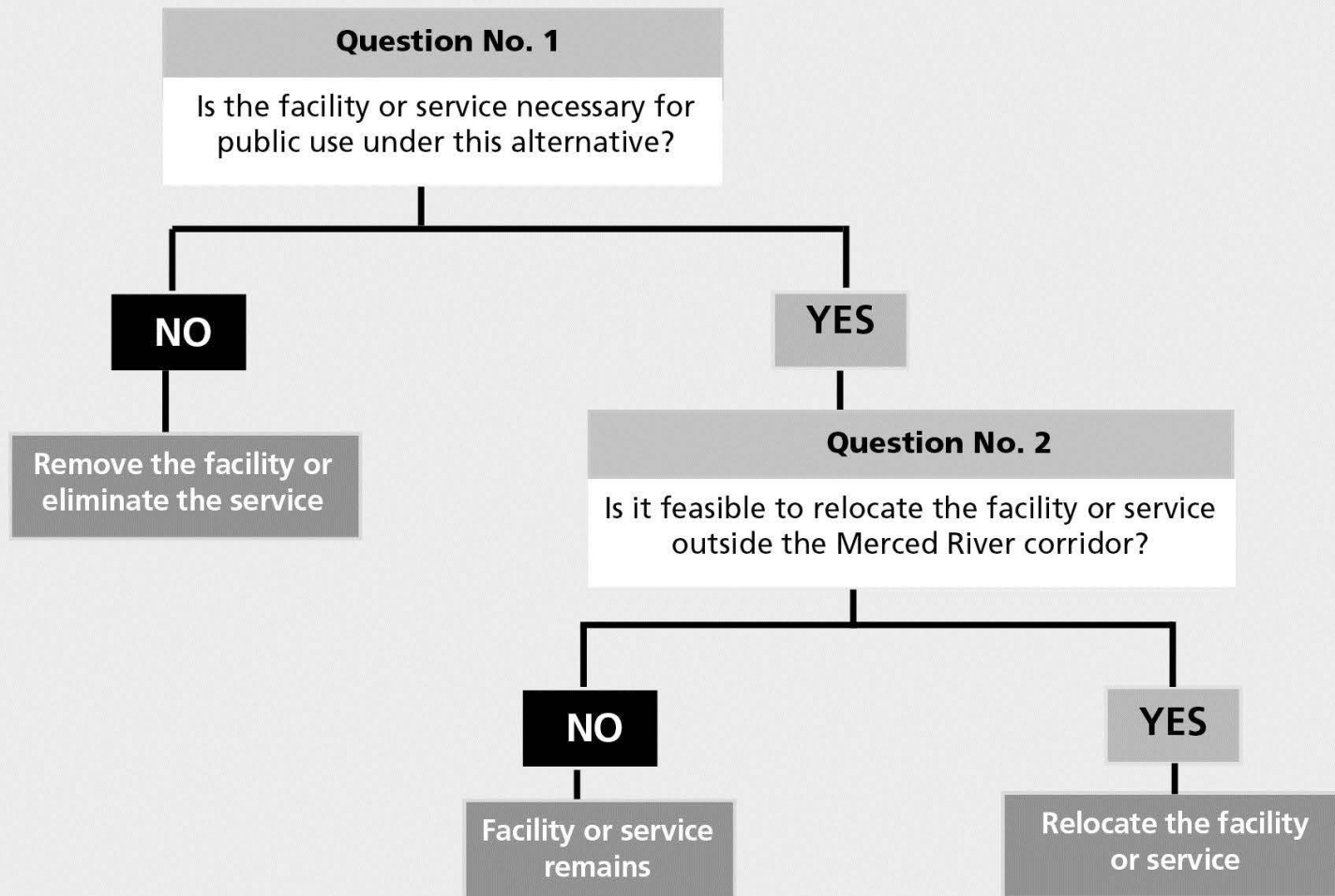

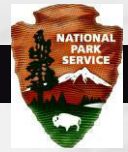

Merced River Plan Facilities Analysis

5 “To illustrate the level of degradation already experienced in the Merced and maintained under the regime of interim limits proposed by NPS, we need look no further than the dozens of facilities and services operating within the river corridor, including but not limited to, the many ...

-- (*Friends of Yosemite v. Kempthorne*, 9th Circ., 2008)

... swimming pools, tennis courts, mountain sports shops, restaurants, cafeterias, bars, snack stands, and other food and beverage services, gift shops, general merchandise stores, an ice-skating rink, an amphitheater, a specialty gift shop, a camp store, an art activity center, rental facilities for bicycles and rafts, skis and other equipment, a golf course and a dining hall accommodating 70 people.”

Yosemite Valley and Merced River

Yosemite Village

Housekeeping Camp

Curry Village

Camping

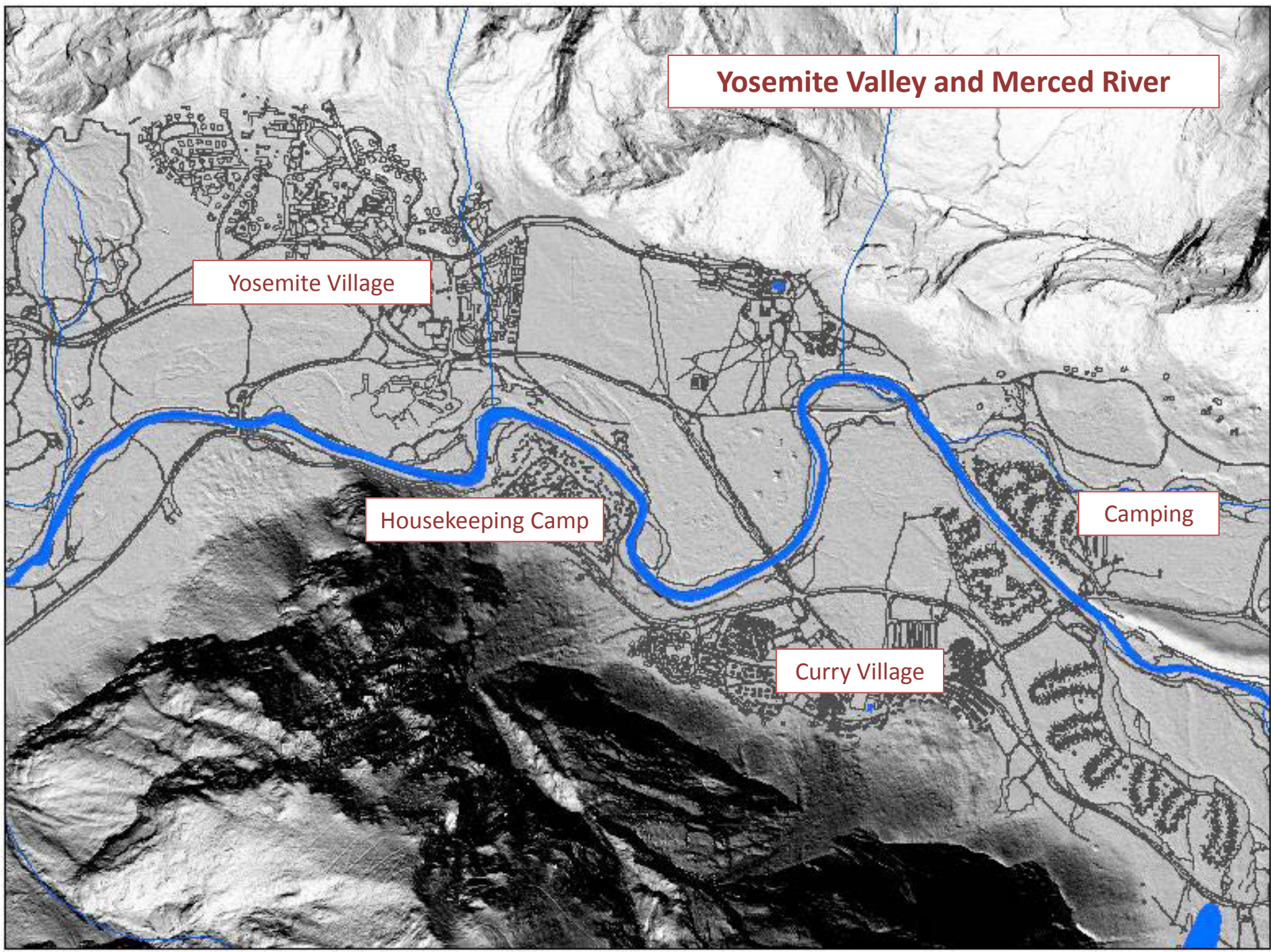

A topographic map of Yosemite Valley, California, showing the Merced River and surrounding terrain. A white, irregularly shaped area highlights the high-water mark of a past event, likely a major flood. The map includes labels for several locations: Yosemite Village in the upper left, Housekeeping Camp in the center, Curry Village in the lower center, and Camping on the right. A large white box at the top right contains the text 'High-Water Mark'.

High-Water Mark

Yosemite Village

Housekeeping Camp

Curry Village

Camping



100-Year Floodplain

Yosemite Village

Housekeeping Camp

Curry Village

Camping

A topographic map of a river valley. A white, irregularly shaped corridor follows the river's path. The map shows terrain contours, a river, and several settlements. Labels in red-bordered boxes identify 'Yosemite Village' on the left, 'Curry Village' on the right, 'Housekeeping Camp' in the center, and 'Camping' on the right. A large red-bordered box at the top right contains the text 'Quarter-Mile River Corridor Boundary'.

Quarter-Mile River Corridor Boundary

Yosemite Village

Housekeeping Camp

Camping

Curry Village

Quarter-Mile Boundary and Edge of Talus



Yosemite Village

This map fragment shows a cluster of buildings and roads, representing the village area.



Housekeeping Camp

This map fragment shows a road and a small structure, representing the housekeeping camp.



Camping

This map fragment shows a road and a small structure, representing the camping area.



Curry Village

This map fragment shows a small structure, representing Curry Village.

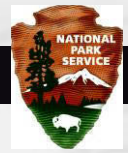

Draft Preferred Alternative

- Ensures that the experiences enjoyed by generations of families are sustained over time.
- Provides visitors the choice of accessing Yosemite Valley by private vehicle or transit.
- Reduces traffic congestion and crowding with organized and efficient day-use parking.
- Creates a sense of arrival by redesigning the primary day-use parking area and removing industrial and administrative functions.
- Improves circulation, reduces congestion and provides for a more relaxed visitor experience.





Providing Access



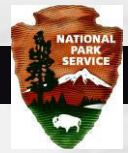

Yosemite Village Day-Use Parking Area (Camp 6)

Current Condition

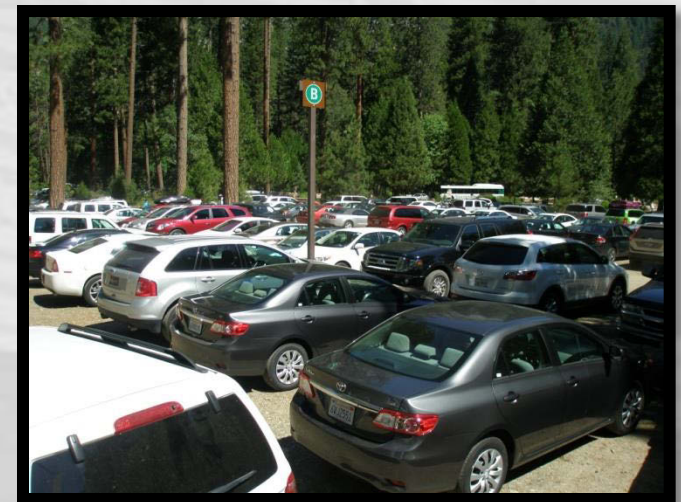



Yosemite Village Day-Use Parking Area

Parking Pulled Back from River

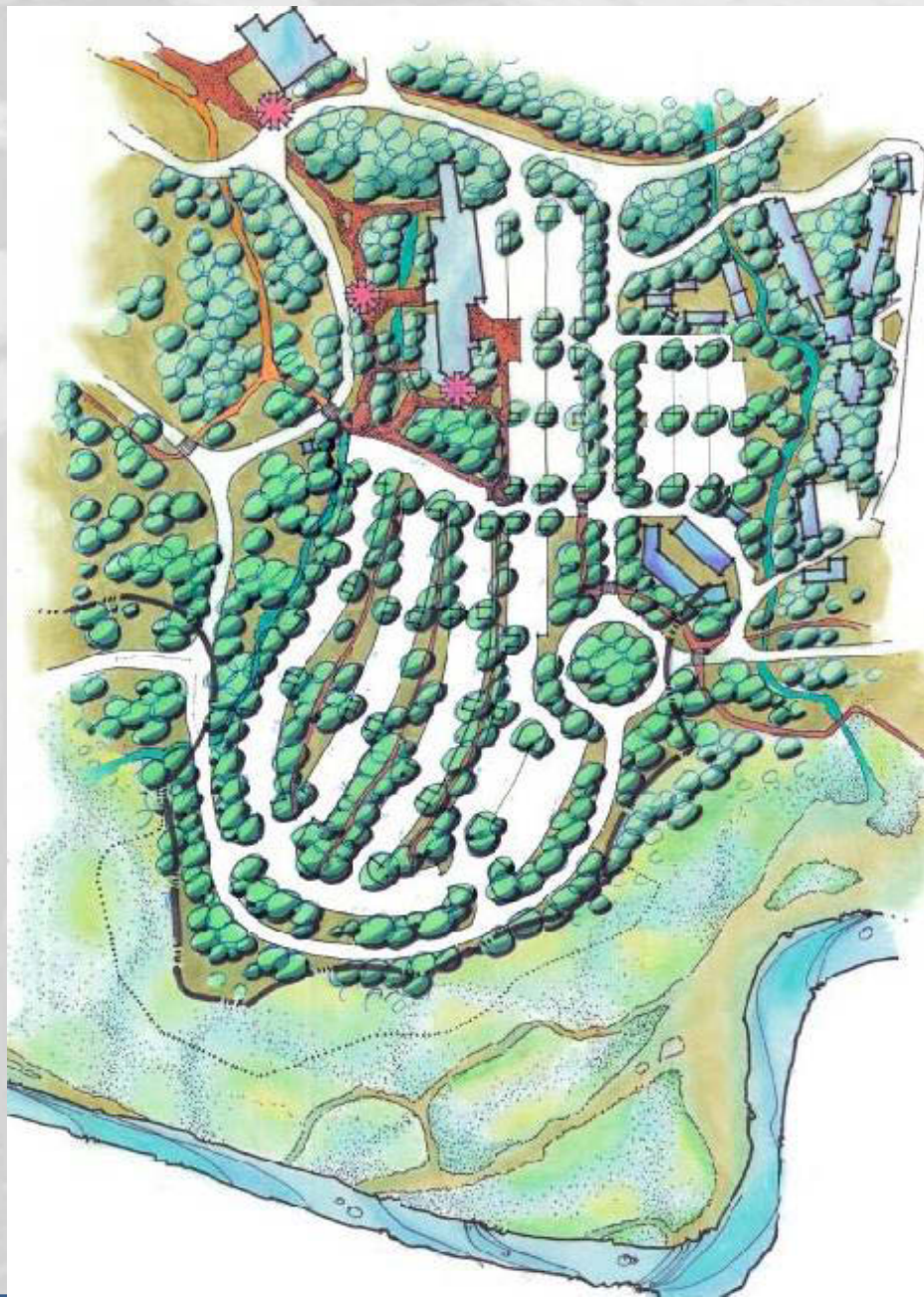

Yosemite Village Day-Use Parking Area

**Draft
Preferred Alternative**

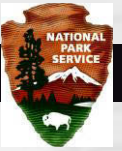

Yosemite Lodge and Camp 4



Draft Preferred Alternative

PROVIDING ACCESS AND PROTECTING RESOURCES

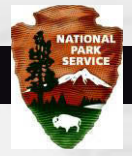

PROVIDING ACCESS AND PROTECTING RESOURCES

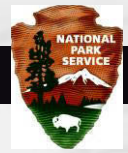

El Portal - Abbieville

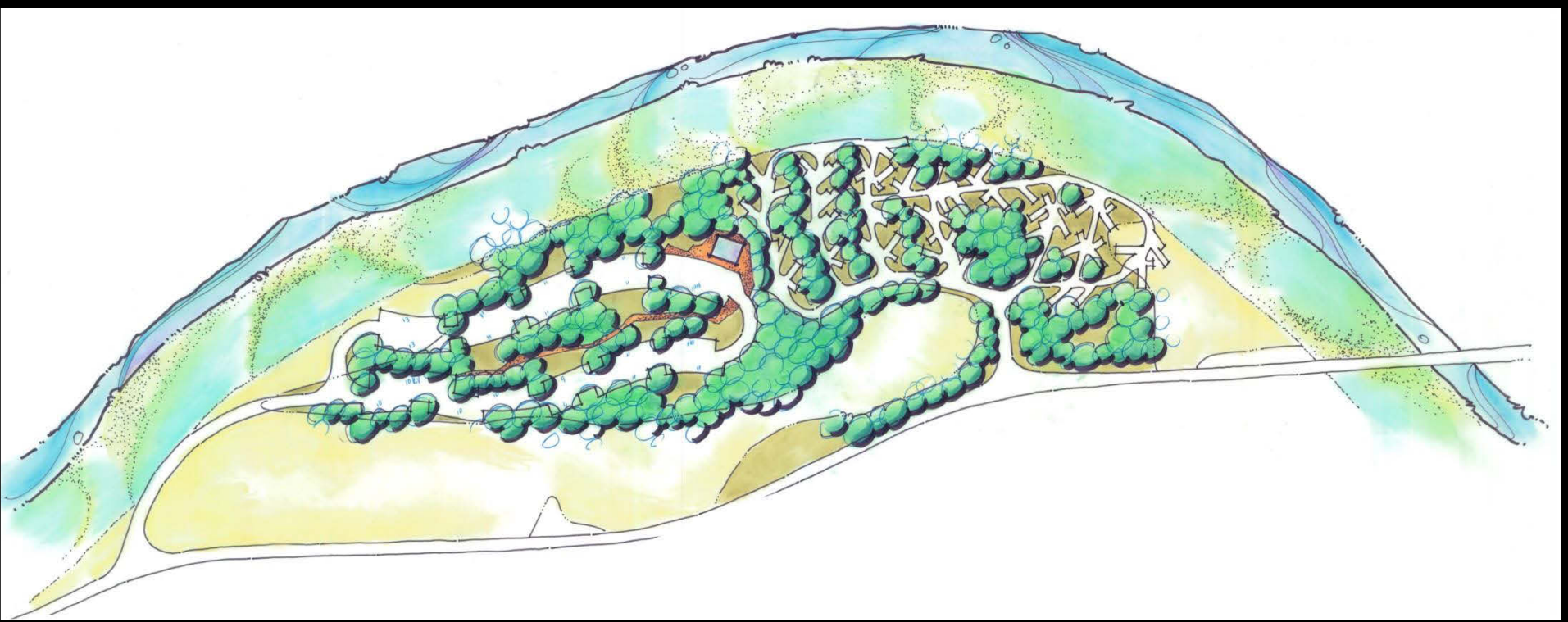

Draft Preferred Alternative

PROVIDING ACCESS AND PROTECTING RESOURCES

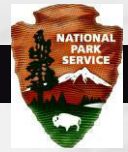

Improving Visitor Experience

- Reduce Congestion and Crowding
- Expand low-cost camping by 37% in Yosemite Valley
- Replace Curry Village tent cabins with hard-sided units
- Provide a "Sense of Arrival" to Yosemite Village area



Upper and Lower River



Camping Units

	Alt 1	Alt 5	Details
Yosemite Valley			
	(No Action)		
Backpackers	25	10+16	16 walk-in sites outside of the 100 year floodplain
Camp 4	35	35 + 35	No change to this National Historic Register site, 35 walk-in sites constructed east of Camp 4
Lower Pines	76	71	5 sites within 100 feet of the river removed
North Pines	86	72	14 sites within 100 feet of the river removed
Upper Pines	240	238 + 87	36-site RV, 49 walk-in, 2 group sites
Yellow Pine Admin Site	4	4	Group administrative sites
Former Upper River	0	30	30 walk-in sites
Eagle Creek	0	42	40 auto sites and 2 group sites
Wawona			
Wawona Campground	99	86	Sites removed within 100 feet of river or culturally sensitive areas
Total Camping in Corridor	565	726	

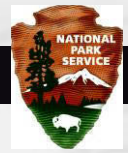

Lodging Units

	Alt 1	Alt 5	Details
(No Action)			
Merced Lake High Sierra Camp	22 (60 beds)	11 (42 beds)	Remove 18 beds
The Ahwahnee	123		No change to National Historic Landmark
Housekeeping Camp	266	232	Remove 34 units from bed and banks
Curry Village	400	453	290 tents and 163 hard-sided units
Yosemite Lodge	245	245	No changes
Total Valley Lodging	1,034	1,053	
Wawona Hotel	104		No Change to this National Historic Landmark
Total Lodging in Corridor	1,160	1,168	

* El Portal: Private accommodations exist but are not on NPS land; therefore, they are not listed here.

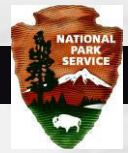

Replace Substandard Housing



Replace temporary, substandard housing with code compliant residences



Old El Portal/Rancheria

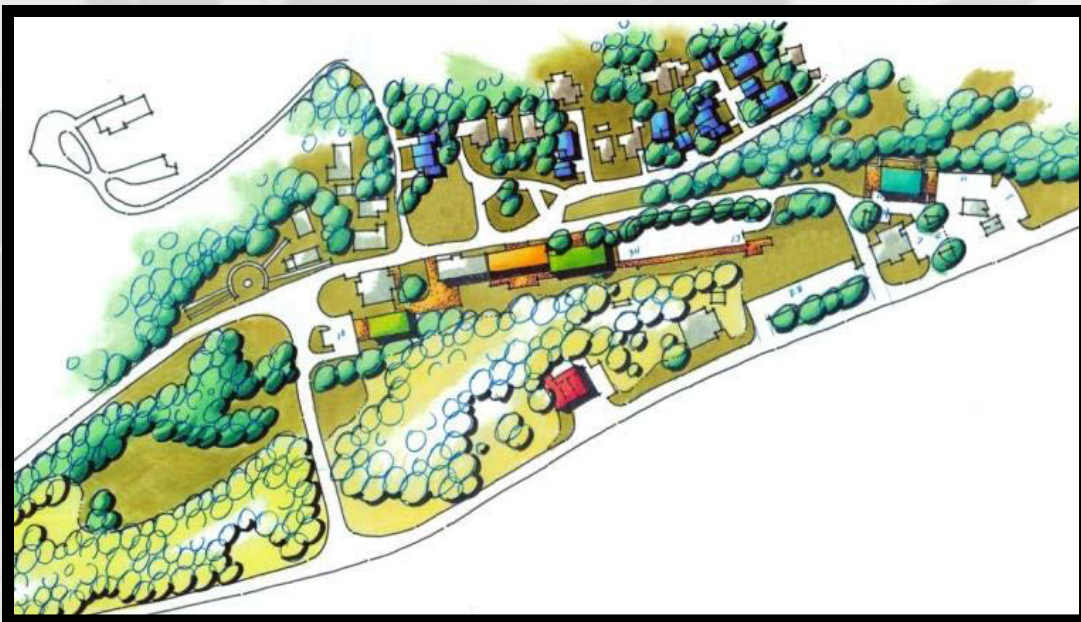

Old El Portal

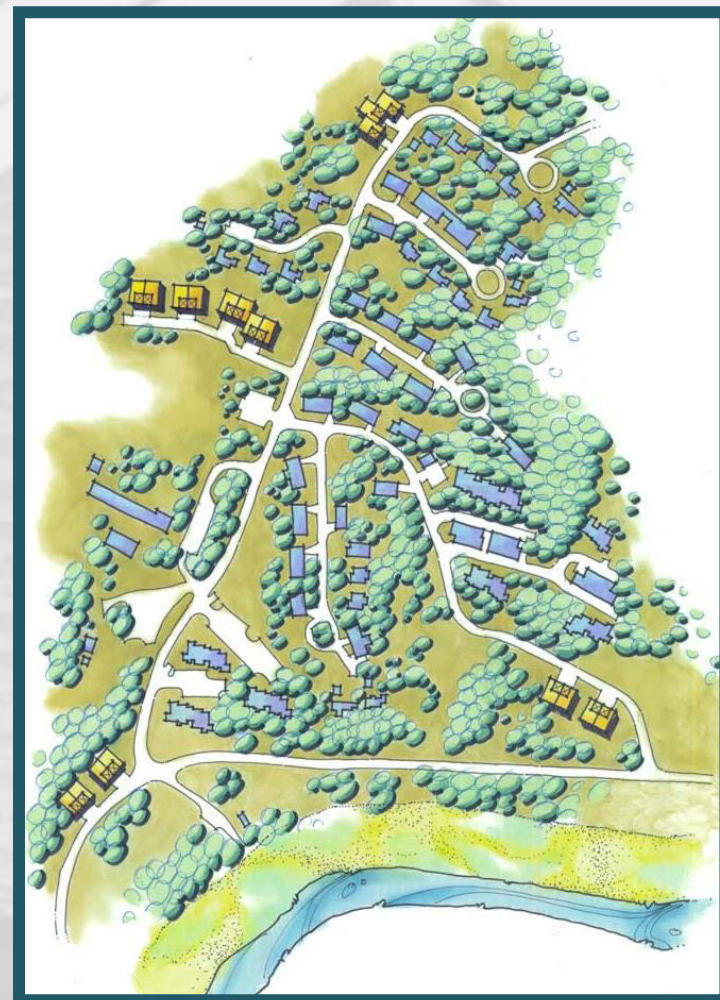

Rancheria

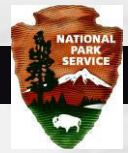

User Capacity/Visitation

East Yosemite Valley Peak-Day:

Current free-flow visitation: 14,800 people

2011 Facility Capacity 14,836 PAOT

+ "capacity of extra cars on road" 3,480 PAOT

= Total 2011 Capacity 18,316 PAOT

2011 Observed Visitation 20,900 people

Alternative 5 Planned User Capacity: 16,683 PAOT

Alternative 5 managed peak-day visitation: 19,900 people

Range of Alternatives – Peak-Day Visitation 13,200 – 21,800 people

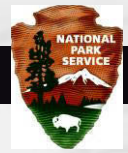

Merced River Plan's Range of Alternatives

Actions	No Action	Alt 2	Alt 3	Alt 4	Alt 5	Alt 6
Acres Restored	0	347	302	223	203	170
Peak East Valley Visitation	20,900	13,900	13,200	17,000	19,900	21,800
Day Visitors	14,800	9,400	8,500	10,500	12,800	13,700
Overnight Visitors	6,100	4,500	4,700	6,500	7,100	8,100
Yosemite Valley Lodging Units	1,034	556	621	823	1,053	1,248
Yosemite Valley Campsites	466	450	477	701	640	739
Parking Spaces for East Valley	5,200	4,000	4,300	4,905	5,600	6,099
Total Project Cost (\$M)		\$263	\$187	\$223	\$235	\$418

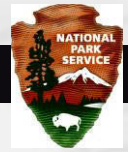

Merced River Plan

Criteria for Project Prioritization

Priority Projects seek to accomplish four major goals:

1. Correct identified impacts to river resources to ensure continued protection
2. Alleviate crowding and congestion and provide for easy access to key park facilities and shuttles
3. Enhance camping opportunities and winter lodging
4. Replace temporary non-code compliant employee housing

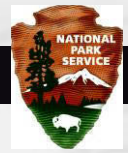

Conceptual Implementation/Phasing

Phase 1

- River Meadow Restoration (Various Projects)
- Improve Sense of Arrival in East Valley (Garage and GO Removal, Replacement Parking at North End, Camp 6 Retrofit, Roundabout, Intersection Redesign)
- Create Code-Compliant Winter Lodging at Curry
(Replace tent cabins in Boystown)
- Create Vehicle Staging Area in West Valley
- CAMP 4 Campground Site Expansion
- Provide Underpass for Safe Pedestrian Access to YOSE Falls

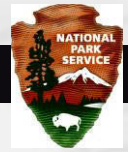

Phase 2

- Replace Camping - Upper Pines Loop
- Replace Camping - Upper/Lower Rivers, Eagle Creek
- Replace Temp Concession Housing (Huff House)
- Replace Temp Concession Housing (Yosemite Lodge)
- Create Out-of-Valley Parking at El Portal
- Replace Temp Concession Housing (Lost Arrow)
- Relocate Wawona Maintenance Facility
- Replace Valley Housing with El Portal/Rancheria In-fill

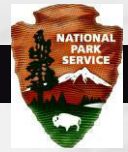

Merced River Draft Plan

- **Public Meetings**
 - March 7: Mariposa
 - March 14: Oakhurst
 - March 15: Wawona
 - March 20: Groveland
 - March 21: San Francisco
 - March 26: Los Angeles
- **Comment Analysis – April and May 2013**
- **Final Plan/Record of Decision: July 2013**

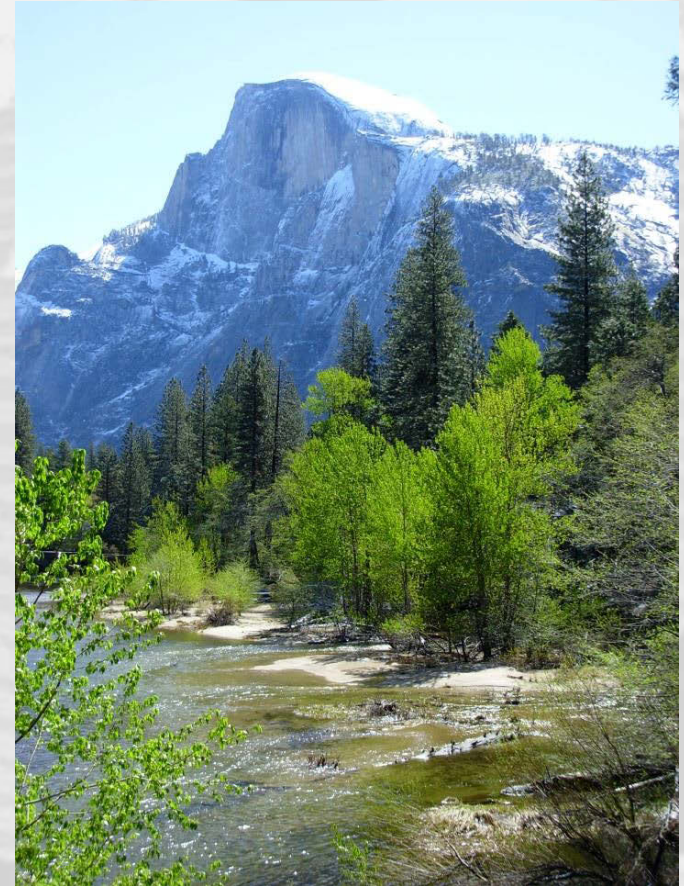

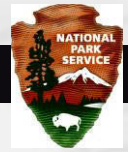

Merced Public Review & Comment Periods

Merced River Plan

- 100-day review period
- Comment period closes April 18

Comment

Online:

http://parkplanning.nps.gov/mrp_deis

Mail:

National Park Service

Merced River Plan

P.O. Box 577

Yosemite, CA 95389

Email: yose_planning@nps.gov

Fax: 209 / 379-1294

