

Giacomini Land Exchange: 2006 Notice of Realty Action - Map 1: Overview Map of the Giacomini Wetlands

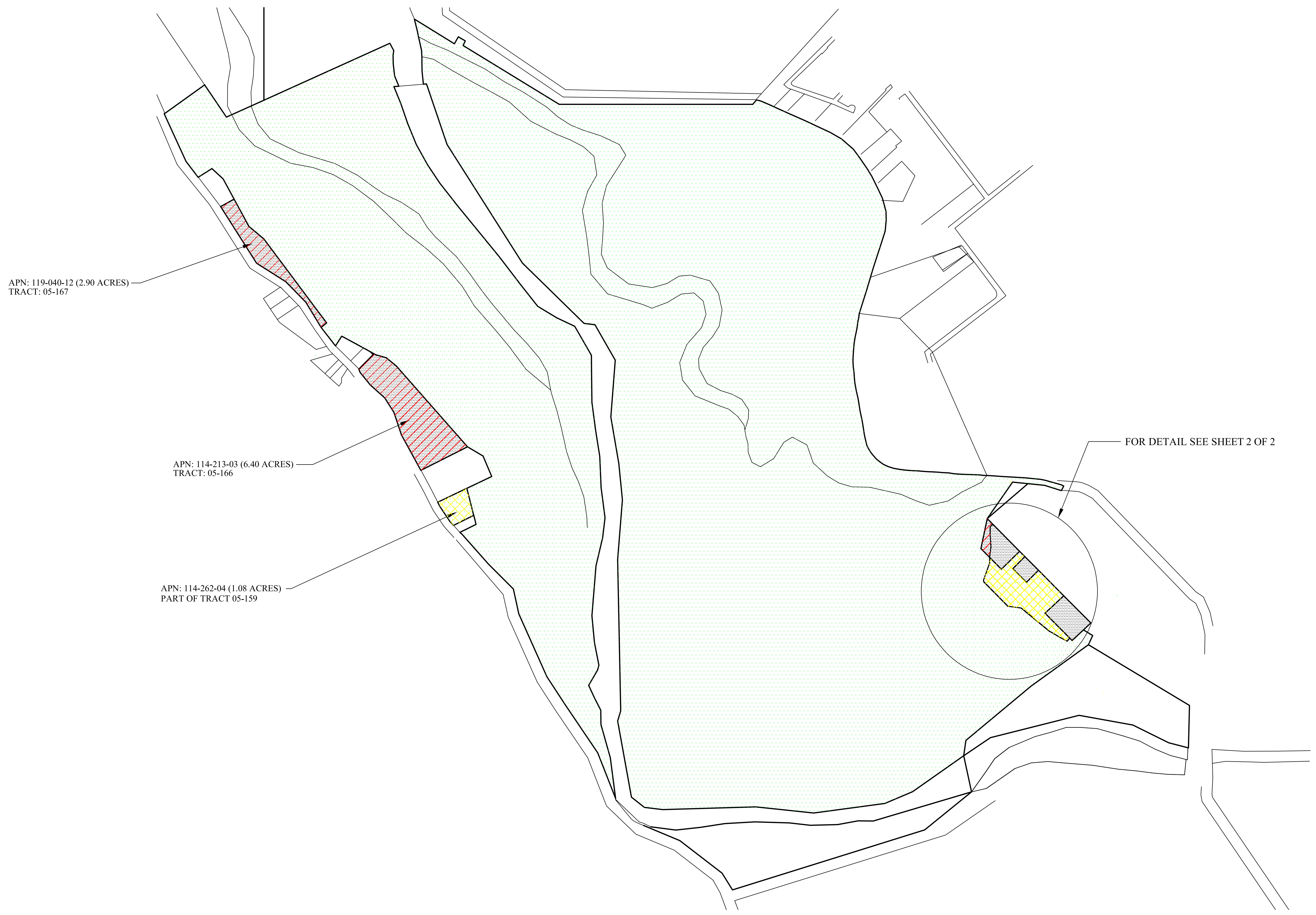

LEGEND

	NPS TRACT 05-159
	GIACOMINI PROPERTY
	NPS PROPERTY TO BE CONSIDERED FOR EXCHANGE
	GIACOMINI PROPERTY TO BE CONSIDERED FOR EXCHANGE

GENERAL NOTE:
 1. Property ownership data compiled from deeds, plats, surveys, and other source data are shown on this base. This is not an engineering quality drawing and should be used for general scaling purposes only. Acreages have been derived from deeds, surveys, and office compilations.

ESTABLISHED: OCTOBER 27, 1972

DATE DRAWN: AUGUST 7, 2003

DATE REVISED:

PACIFIC LAND RESOURCES PROGRAM CENTER
 PACIFIC WEST REGION

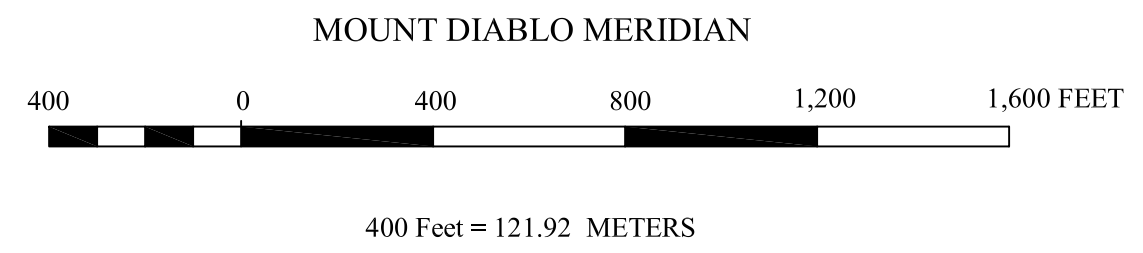

DN. BY: E.O.S	CK. BY: N.W.
APPR. BY:	
REGION: P W R O	
DRAWING NO:	
SHEET: 1 OF 2	

**UNITED STATES
 DEPARTMENT OF THE INTERIOR**

NATIONAL PARK SERVICE
 LAND RESOURCES PROGRAM CENTER

**GOLDEN GATE
 NATIONAL RECREATION AREA**

MARIN COUNTY
 CALIFORNIA

TITLE:
 NPS AND GIACOMINI EXCHANGE