

THE WASHINGTON MALL

1936 DEVELOPMENT PLAN

PREPARED FOR THE NATIONAL PARK SERVICE  
DEPARTMENT OF THE INTERIOR, UNITED STATES OF AMERICA  
BY SKIDMORE, OWINGS & MERRILL      OCTOBER, 1935

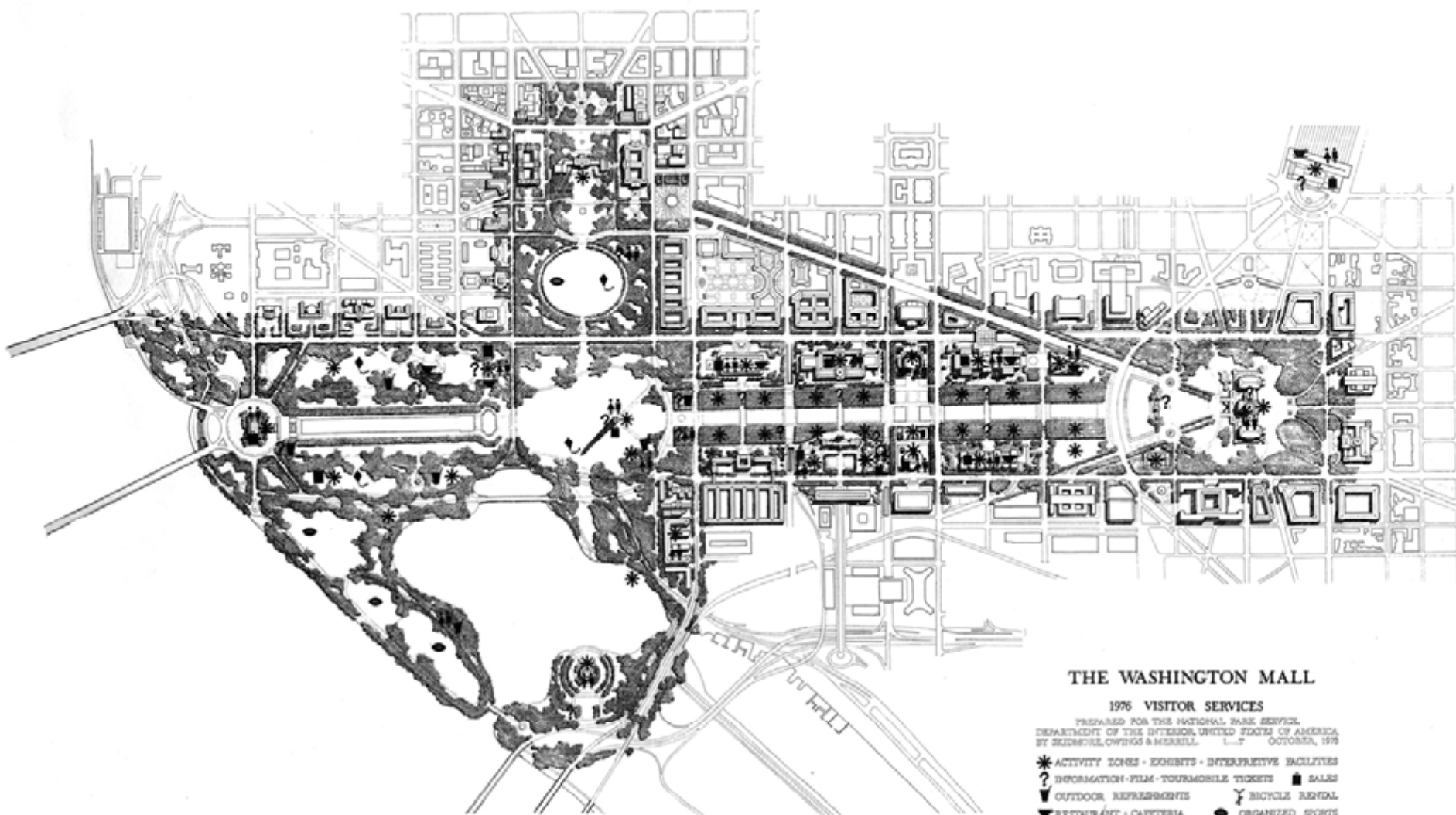

### THE WASHINGTON MALL

1976 VISITOR SERVICES

PREPARED FOR THE NATIONAL PARK SERVICE  
DEPARTMENT OF THE INTERIOR, UNITED STATES OF AMERICA  
BY SKIDMORE, OWINGS & MERRILL 1-7 OCTOBER, 1975

- \* ACTIVITY ZONES - EXHIBITS - INTERPRETIVE FACILITIES
- ? INFORMATION - FILM - TOURMOBILE TICKETS ■ SALES
- ∨ OUTDOOR REPRESENTIVES √ BICYCLE RENTAL
- ☰ RESTAURANT - CAFETERIA ● ORGANIZED SPORTS
- ☼ REST ROOMS ☼ INFORMAL RECREATION

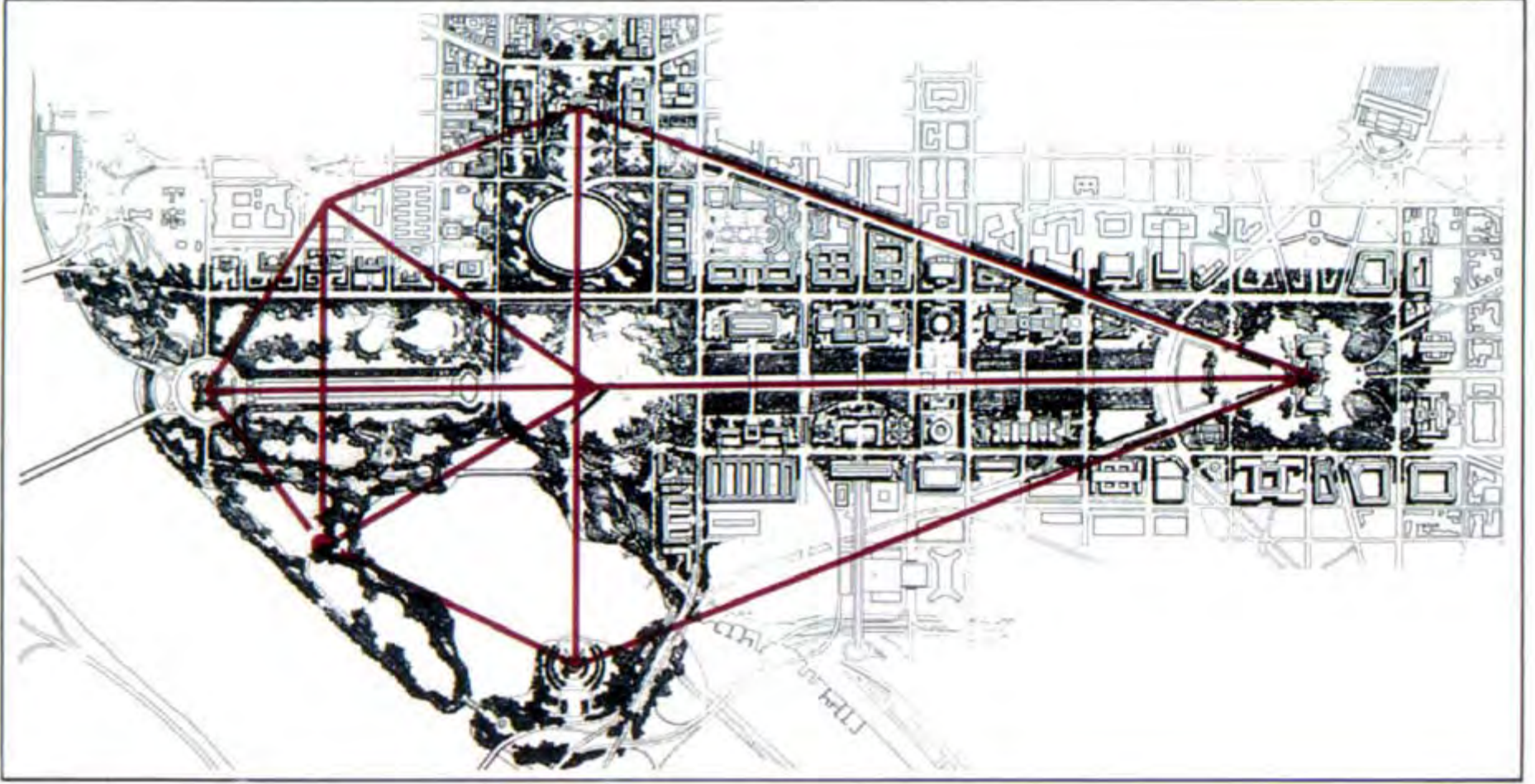



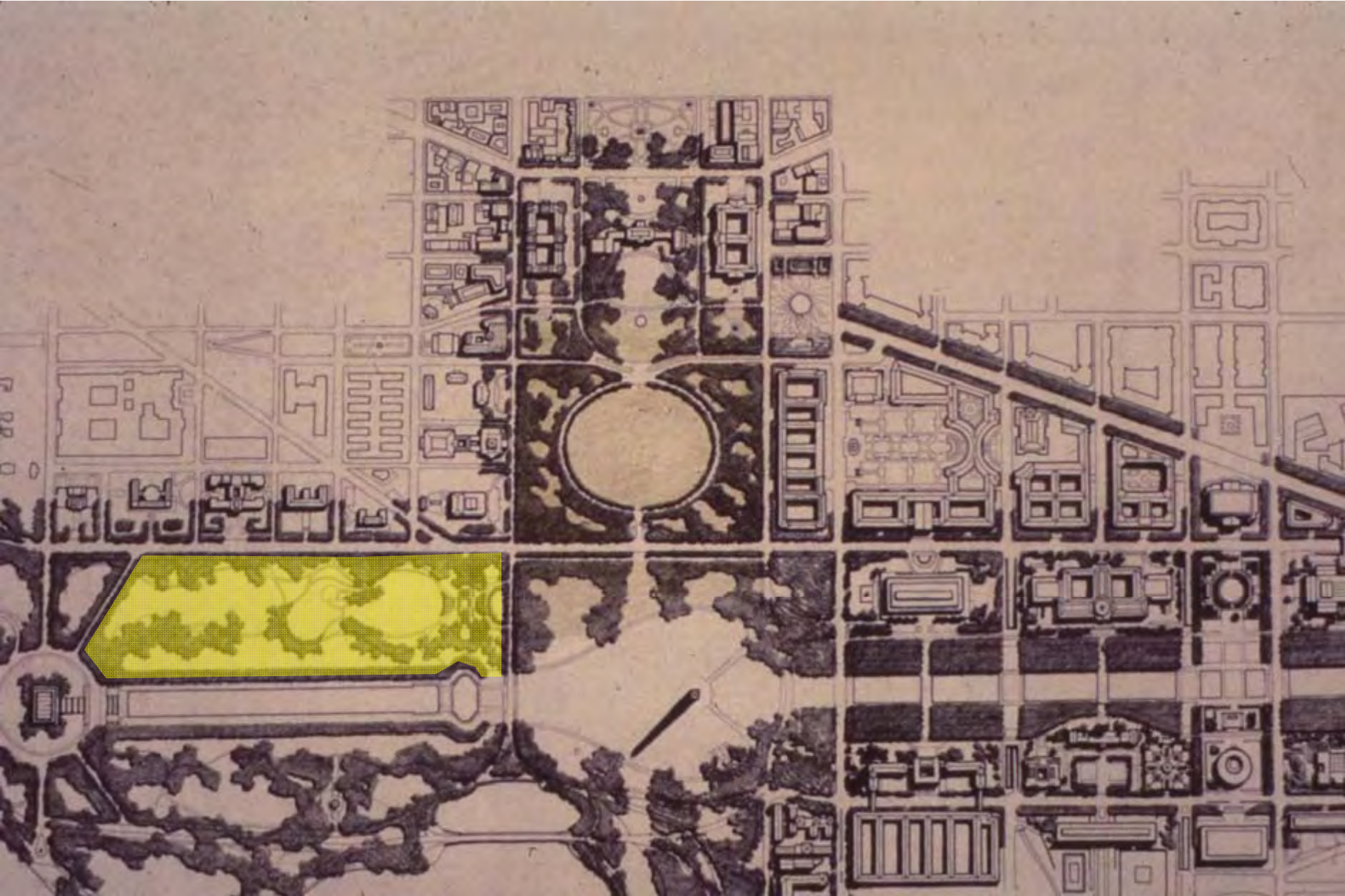





























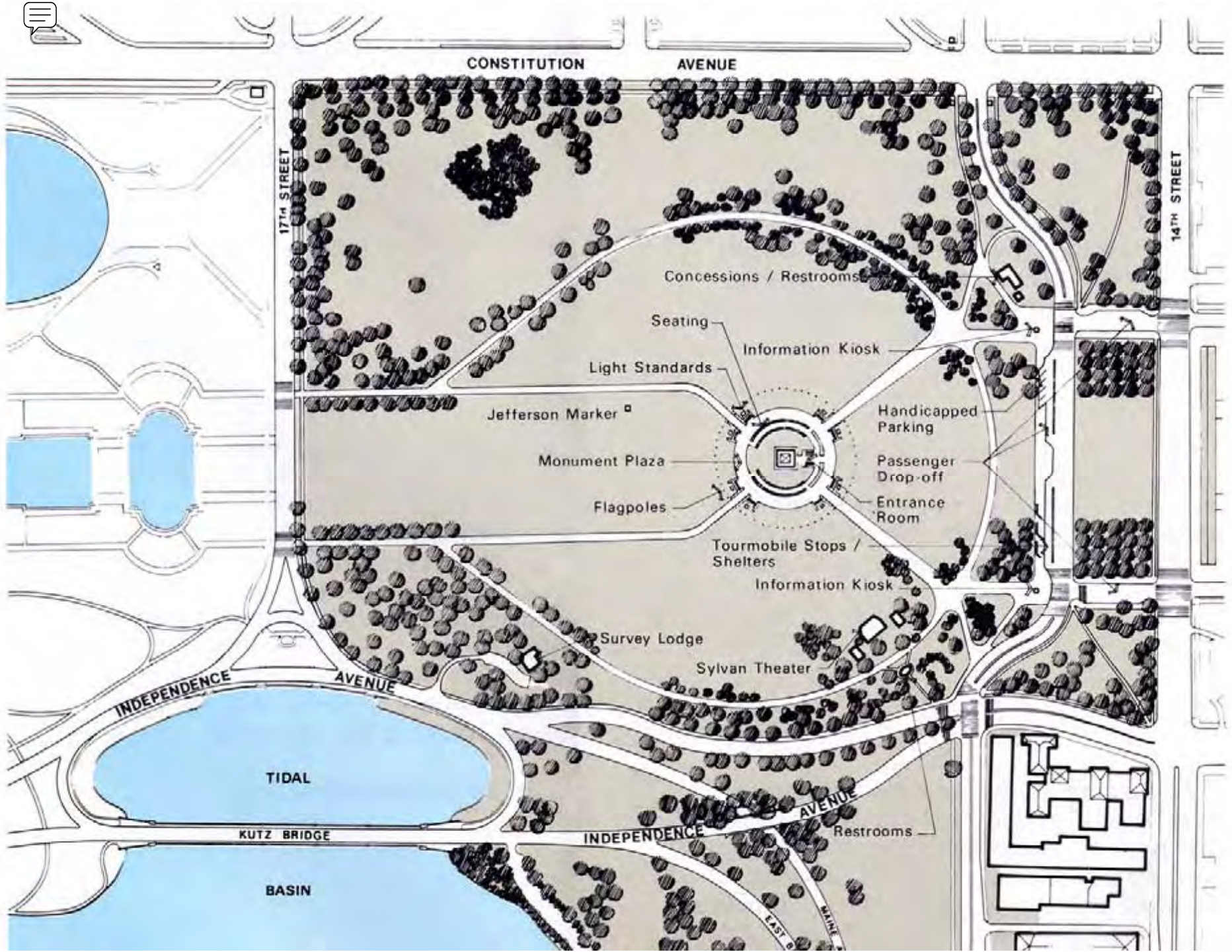

CONSTITUTION AVENUE

17<sup>TH</sup> STREET

14<sup>TH</sup> STREET

Concessions / Restrooms

Seating

Information Kiosk

Light Standards

Jefferson Marker

Monument Plaza

Flagpoles

Handicapped Parking

Passenger Drop-off

Entrance Room

Tourmobile Stops / Shelters

Information Kiosk

Survey Lodge

Sylvan Theater

INDEPENDENCE AVENUE

TIDAL BASIN

KUTZ BRIDGE

INDEPENDENCE AVENUE

Restrooms

EAST B MAIN

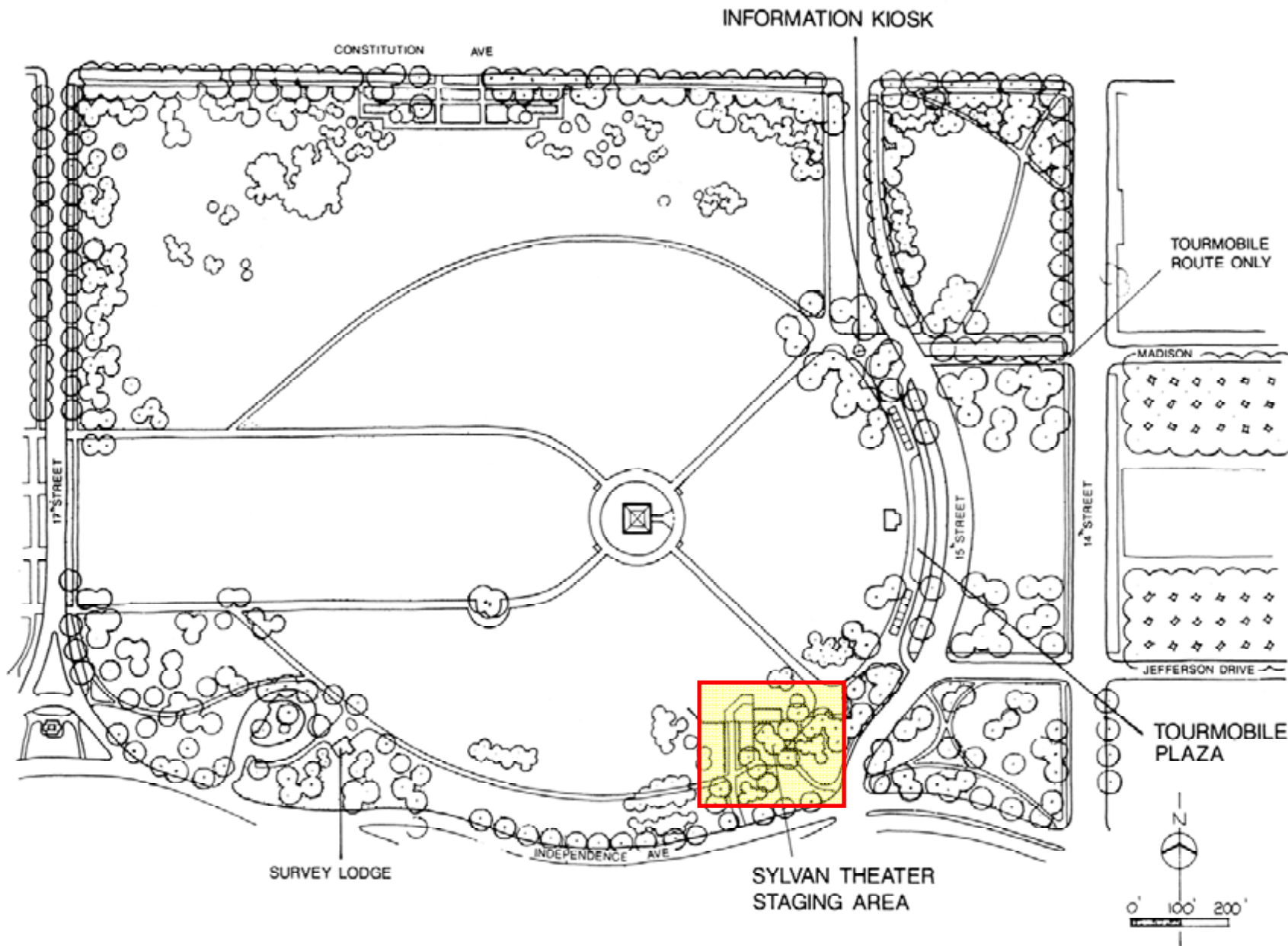

WASHINGTON MONUMENT GROUNDS

MONUMENTAL CORE WASHINGTON D C



Ranger Station

Sylvan Theater

Drop Off

Constitution Ave.

Drop Off

Concessions

Tourmobile

Madison Drive

Underground  
Visitor Center

Jefferson Drive

Tourmobile

Concessions

Independence Ave.

10 20 30 40 50  
May 1993





Constitution Avenue

German-American Friendship Garden

Madison Drive

World War II Memorial

17th Street

15th Street

14th Street

Jefferson Drive

Tidal Basin

Independence Avenue















**Aboveground**

-  Access portal
-  Vehicle gate



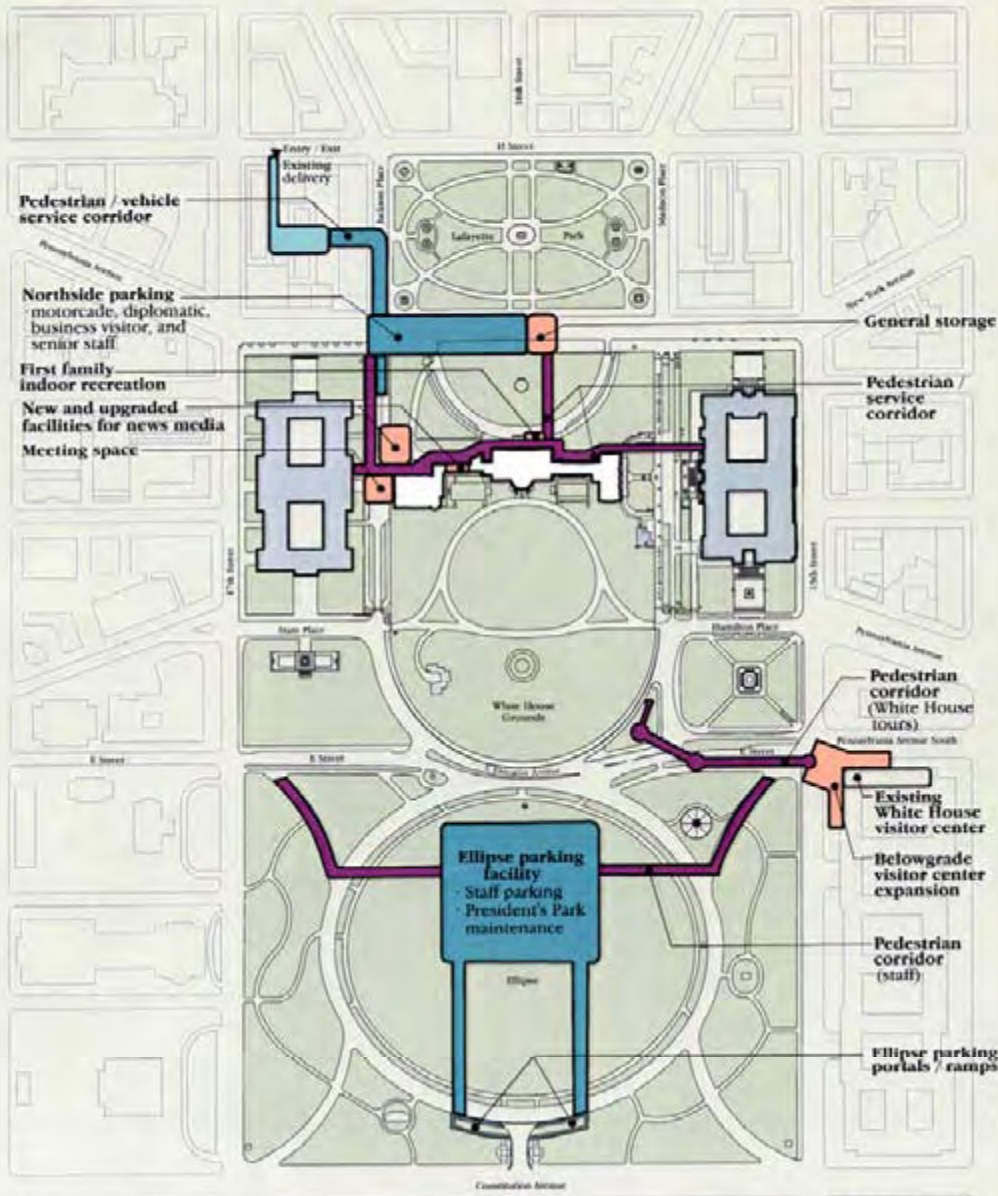

**Belowground**

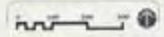



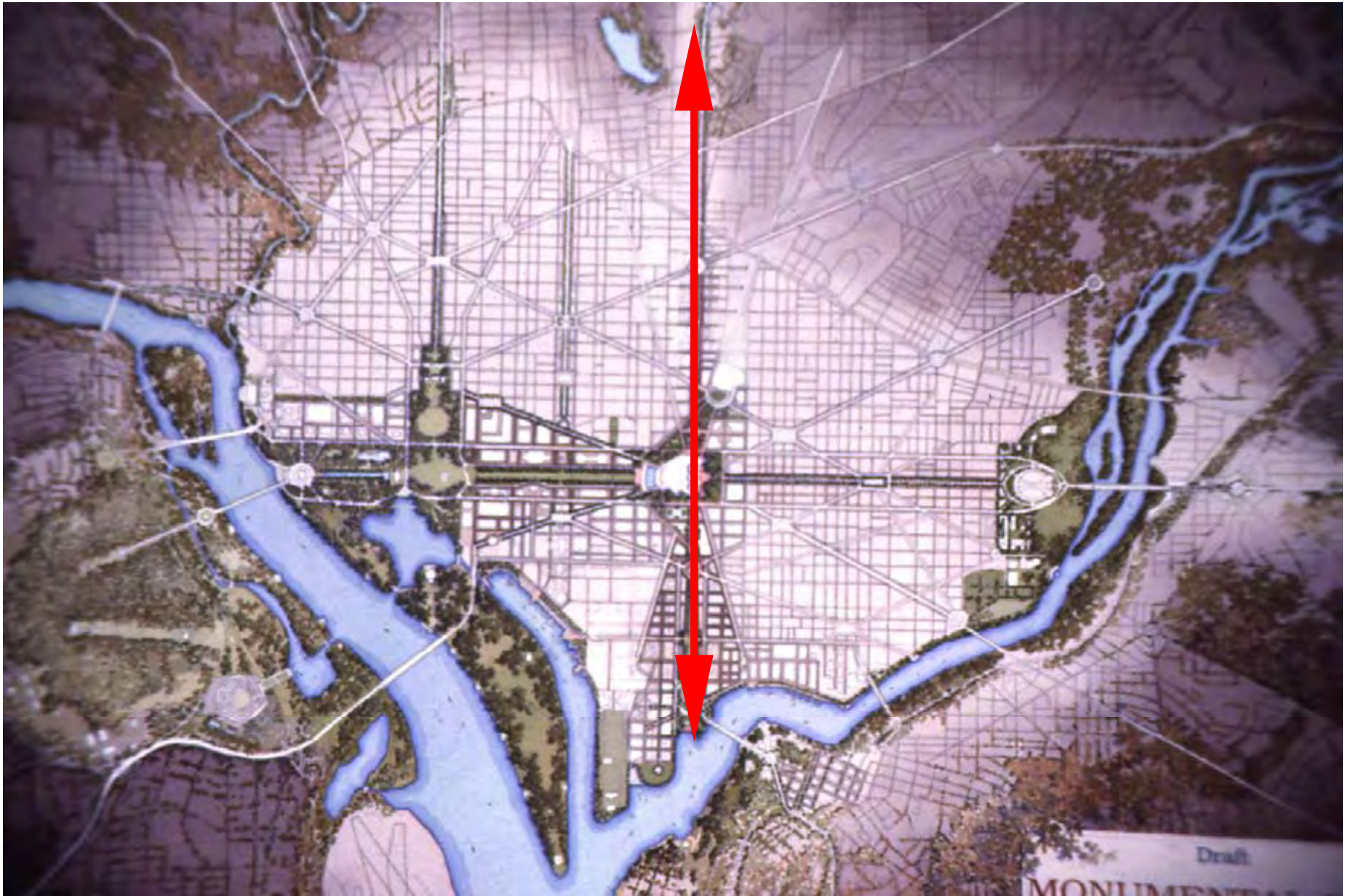

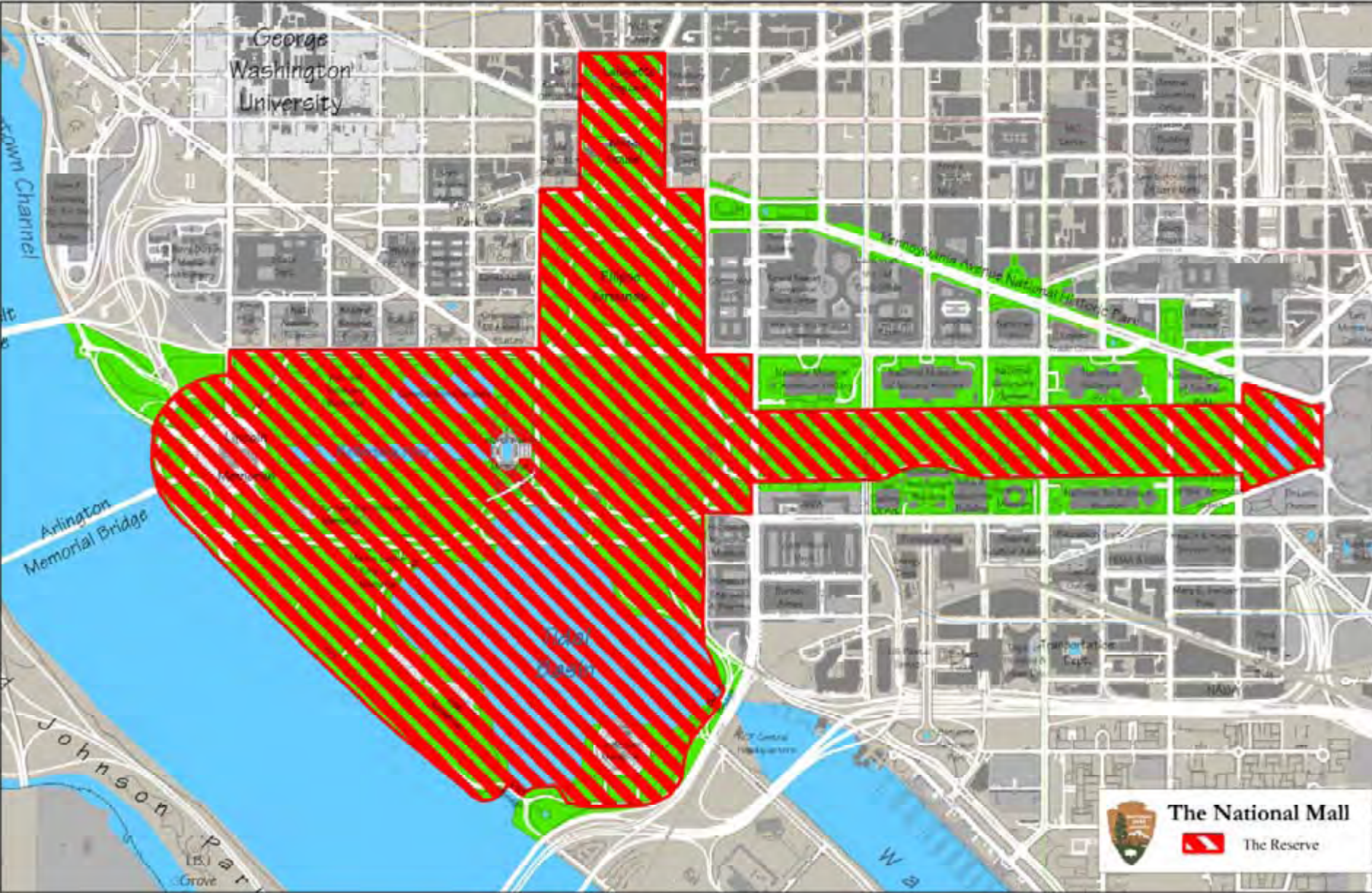











# National Park Service



EXPERIENCE  
YOUR  
AMERICA

